

HANDLES AND SECURITY FITTINGS FOR WINDOWS AND DOORS



Table of Contents G

Item no.	Description	Sct	Pg	Item no.	Description	Sct	Pg
4	Handle	G	140	4207 H	Handle	G	137
8 H	Handle	G	140	4207 V	Handle	G	137
8 V	Handle	G	140	4285	Mounting plate	G	143
17	Handle	G	138	4484	Pushbutton cylinder	G	151
23	Window closer	G	157	4548	Spacer plate	G	144
24	Handle	G	140	4919	Pin	G	151
34	Pull handle	G	154	4926	Mounting plate	G	151
42	Handle	G	137	4986	Spacer device	G	130
42 H	Handle	G	137	5325	Fixing plate	G	146
42 V	Handle	G	137	5365	Fixing plate	G	146
51	Handle	G	140	5816	Cylinder, Vinga	G	128
56	Triangular pin	G	142	7287	Pushbutton cylinder	G	153
70	Window closer	G	157	7310	Cylinder, Vinga	G	128
73	Door handle	G	127	7311	Handle	G	123
76	Handle	G	138	7311	Mounting example, Vinga	G	132
76 H	Handle	G	138	7311	Mounting example, Vinga	G	133
76 V	Handle	G	138	7311 H	Handle	G	123
77D	Catch	G	157	7311 V	Handle	G	123
83	Handle	G	135	7312	Handle, lockable	G	125
83 H	Handle	G	135	7312 H	Handle, lockable	G	125
83 V	Handle	G	135	7312 V	Handle, lockable	G	125
94	Pull handle	G	154	7313	Turn catch	G	129
95	Handle	G	139	7314	Handle, lockable	G	126
95 H	Handle	G	139	7314	Mounting example, Vinga	G	131
95 V	Handle	G	139	7314 H	Handle, lockable	G	126
98	Handle	G	134	7314 V	Handle, lockable	G	126
145	Triangular key	G	142	7315	Handle, lockable	G	126
337	Catch	G	157	7315	Mounting example, Vinga	G	131
338D	Catch	G	157	7315 H	Handle, lockable	G	126
716	Cylinder, Vinga	G	128	7315 V	Handle, lockable	G	126
805	Security device	G	144	7323	Cover plate	G	129
811	Triangular handle	G	144	7335	Turn catch	G	129
823	Cover plate	G	142	7343 H	Handle	G	124
833	Handle coupling	G	137	7343 V	Handle	G	124
833/16	Handle coupling	G	137	7344	Spacer plate	G	130
835S	Security handle	G	145	7352	Fixing plate	G	130
835SH	Security handle	G	145	7360	Handle	G	127
835SV	Security handle	G	145	7390	Key plate	G	127
836S	Security device	G	144	7450	Handle locking device	G	129
837S	Security handle	G	145	7500	Door Guard	G	155
837SH	Security handle	G	145	8307	Handle	G	135
837SV	Security handle	G	145	8307 H	Handle	G	135
840	Handle locking device	G	143	8307 V	Handle	G	135
841S	Mounting plate	G	146	8350S	Security handle	G	147
844S	Security handle	G	150	8350SH	Security handle	G	147
844SH	Security handle	G	150	8350SV	Security handle	G	147
844SV	Security handle	G	150	8465S	Security handle	G	149
850	Handle locking device	G	143	9507	Handle	G	139
876S	Security handle	G	150	9507 H	Handle	G	139
876SH	Security handle	G	150	9507 V	Handle	G	139
876SV	Security handle	G	150	D120416	Handle	G	156
895S	Security handle	G	150	D120417	Handle	G	156
895SH	Security handle	G	150	D150016	Sliding door ring	G	156
895SV	Security handle	G	150	D150043	Sliding door ring	G	156
961	Handle coupling	G	137	D150045	Sliding door recess grip	G	156
1857	Plate	G	142	D150046	Sliding door recess grip	G	156
1857T	Plate	G	142	G210216405	Handle, stainless steel	G	141
2130	Handle set, lockable	G	148	G210216415 H	Handle, stainless steel	G	141
2162	Handle	G	136	G210216425 V	Handle, stainless steel	G	141
2265	Handle	G	149	G210316405	Handle, stainless steel	G	141
2265S8350	Security handle	G	149	G210316415 H	Handle, stainless steel	G	141
2384	Receiver	G	149	G210316425 V	Handle, stainless steel	G	141
2820	Window lock	G	152				
2830	Window lock	G	152				
2830E	Window lock with indication	G	152				
4207	Handle	G	137				

Vinga, handle for windows and glazed doors, Fix 7311

PATENT/REGISTERED DESIGN

Fix 7311 is a handle for both older and newer architecture. The handle is available in straight, right and left versions.

Operation

Fix 7311 has a cover plate for hidden screw mounting. The handle is pressed into the plate with a unique snap-in mounting. The grip is easily loosened and replaced with a different grip, e.g. lockable, or a grip with a different surface treatment.

Material

Handle and cover plate, chrome plated, satin chrome or brass zamak plating.

(Epoxy powder paint and miralloy on request). Spindle, square 8 mm, galvanized steel. The handle may be delivered with 7 mm square on special order. For increased corrosion protection of external handle, epoxy powder paint is recommended. Spindle length: 33, 43, 53 mm.

Accessories:

Handle locking device Fix 7450, page G 129.
Handle coupling, page G 137.

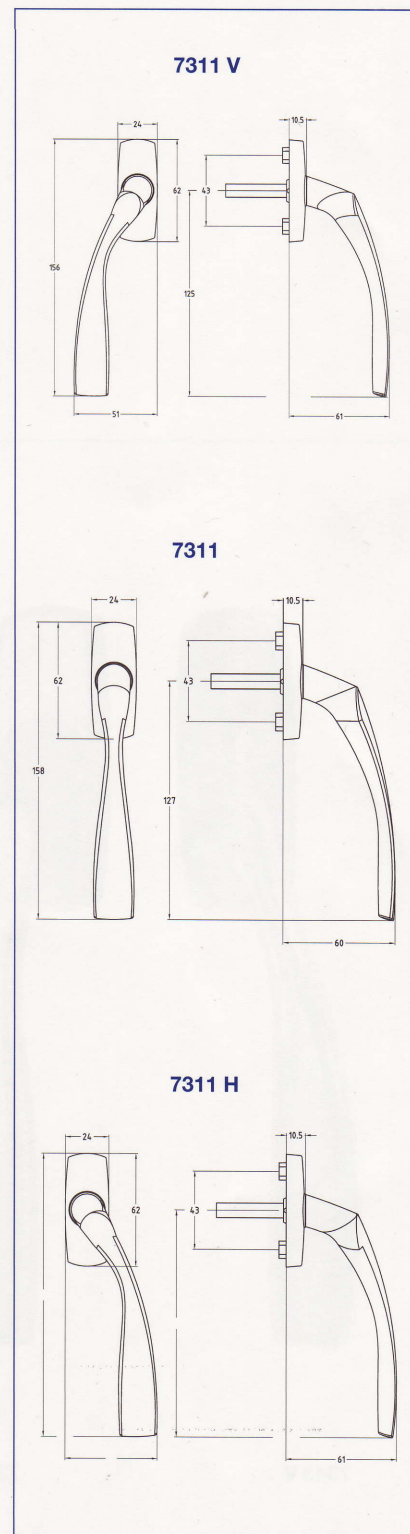

7343

Vinga, handle for windows, Fix 7343

PATENT/REGISTERED DESIGN

Fix 7343 is a handle for both older and newer architecture. The handle is available in straight, right and left versions. The handle is meant for smaller windows.

Operation

Fix 7343 has a cover plate for hidden screw mounting. The handle is pressed into the plate with a unique snap-in mounting. The grip is easily loosened and replaced with a different grip, e.g. lockable, or a grip with a different surface treatment.

Material:

Handle and cover plate, chrome plated, satin chrome or brass zamak plating. (Epoxy powder paint and miralloy on request). Spindle, square 8 mm, galvanized steel. The handle may be delivered with 7 mm square on special order. For increased corrosion protection of external handle, epoxy powder paint is recommended.

Spindle length: 33, 43, 53 mm.

Accessories

Handle locking device F7450, page G 129.

Handle coupling, page G 137.

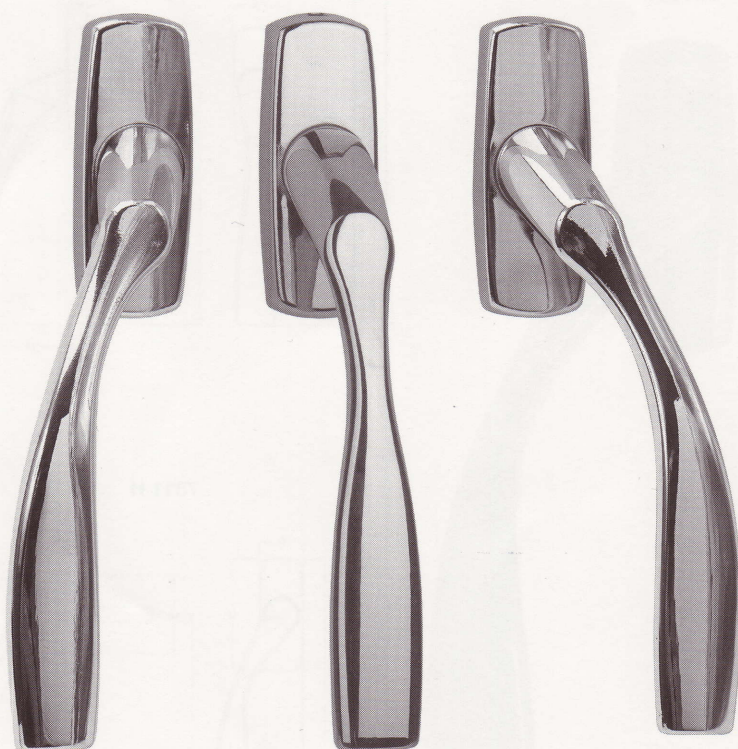

7343 V

7343

7343 H

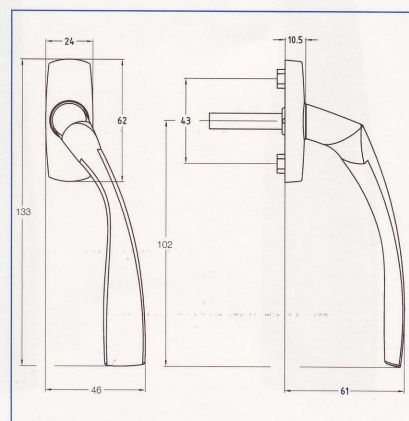

Vinga, security handle for windows and glazed doors, Fix 7312

PATENT/REGISTERED DESIGN

Fix 7312 is a lockable handle for both older and newer architecture. The handle is available in straight, right and left versions.

Operation

Fix 7312 has a cover plate for hidden screw mounting and the screws are blocked when the handle is in a locked position. The handle is pressed into the plate with a unique snap-in mounting. The grip is easily loosened and replaced with a different grip, e.g. non-lockable, or a grip with a different surface treatment.

Material

Handle and cover plate, chrome plated, satin chrome or brass zamak plating. (Epoxy powder paint and miralloy on request). Spindle, square 8 mm,

galvanized steel. The handle may be delivered with 7 mm square on special order. For increased corrosion protection of external handle, epoxy powder paint is recommended. Spindle length: 53 mm

Accessories:

Cylinder, see page G 128.
Handle coupling, see page G 137.

Note:

Approved according to SS 3620, classification B.

7312 V

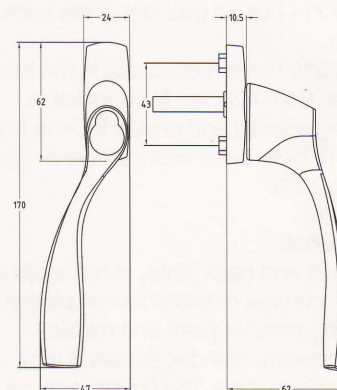

7312

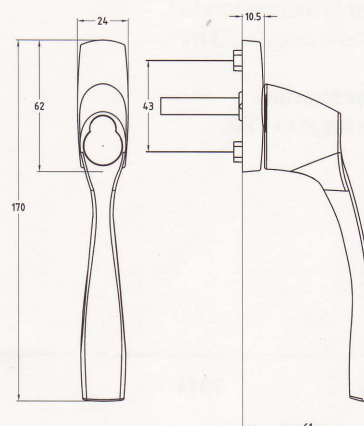

7312 H

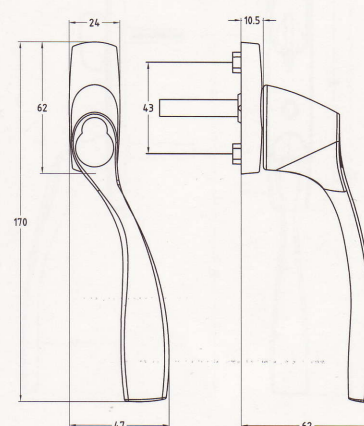

7312 V

7312

7312 H



7314
7315

Vinga handles for glazed doors with lockable espagnolette Fix 7314 and 7315

REGISTERED DESIGN

Fix 7314 and 7315 are handles for both older and newer architecture. The size and design of the handle makes it easy to operate even old and large doors.

Operation

Fix 7314 has an oval slot in the back plate.

Fix 7315 has a rococo slot in the back plate. Both handles fit Fix lockable espagnolettes and enable locking from one or both sides with cylinder and/or turn catch.

Material:

Handle and back plate, chrome plated, satin chrome or brass zamak plating. (Epoxy powder paint and miralloy on request). Spindle, square 8 mm, galvanized steel. The handle may be delivered with 7 mm square on special order. For increased corrosion protection of external handle, epoxy powder paint is recommended. Spindle length: 53 mm.

Accessories:

See page G 129.

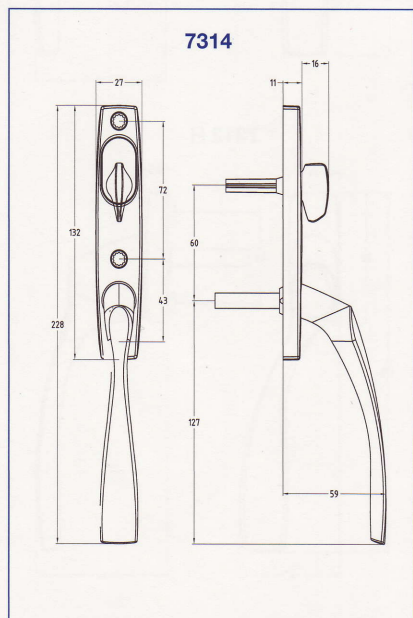

Vinga, handle for internal doors, Assa 73

73
7360
7390

REGISTERED DESIGN

Assa 73 is a door handle in the Vinga series, which enables a fitting solution with a consistent design for both windows and doors.

Assa 7360 is an accessory for the Assa 73 handle. The handle fits FAS 2020, ABLOY 2014, 414 and 40T. Assa 7390 is an accessory for the Assa 73 handle. The handle fits FAS 2020, FAS 40C and ABLOY 2014.

Operation

The handle is intended for lighter internal doors in the private housing sector. Installation is done with two penetrating M5 screws and fixed nipples. The handle is adapted to a 40 mm door thickness. The turn catch is marked red/white on the outside and inside. The turn catch is mounted with two M5 screws and fixed nipples. The plate is mounted with two penetrating M5 screws and fixed nipples.

Material:

Chrome plated, satin chrome and brass plating.

Assa 7360 is an accessory for the Assa 73 handle. The handle fits FAS 2020, ABLOY 2014, 414 and 40T.

Assa 7390 is an accessory for the Assa 73 handle. The handle fits FAS 2020, FAS 40C and ABLOY 2014.

Operation

The handle is intended for lighter internal doors in the private housing sector. Installation is done with two M5 screws and fixed nipples. The handle is adapted to a 40 mm door thickness.

The turn catch is marked red/white on the outside and inside. The turn catch is mounted with two penetrating M5 screws and fixed nipples. The plate is mounted with two penetrating M5 screws and fixed nipples.

Material:

Chrome plated, satin chrome and brass plating.

Note:

Ordered from ASSA.

7360 turn catch

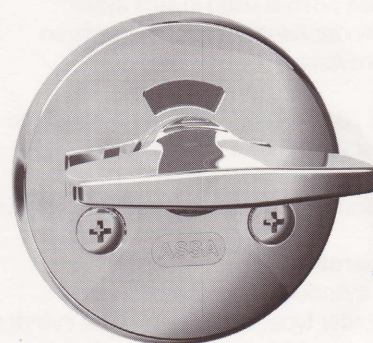

7360 outside

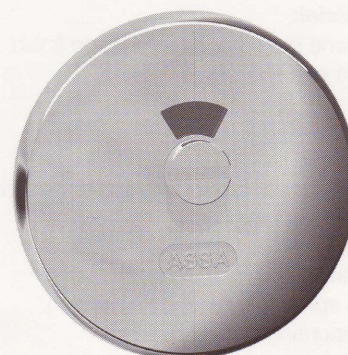

7390



73



716
5816
7310

Vinga, cylinders for Fix 7312

Used for handle Fix 7312.

Assa 716 goes with Assa Max for the DIY market.

Assa 5816 is used in lock system. Cylinder Assa 716/5816 is ordered from Assa AB.

Fix 7310 is a cylinder, which offers the user keyed-alike or different locking.

Cylinder Fix 7310 is ordered from FIX AB.

Operation

All cylinders are of the pushbutton cylinder type, meaning that the cylinder is pushed into the handle for locking. When opening, the cylinder returns to the unlocked position. The key can be removed in both locked and unlocked position.

Material:

Chrome plated or satin chrome finish (Assa and Fix).

Brass plated (Fix).

Miralloy, satin brushed brass or brown oxidation (Assa).

Installation:

With spring pin for easy mounting/dismounting in the Fix handle.

Note:

Meets the requirements for lockable windows and glazed doors according to Swedish Standard, SS 3620 classification B.

Assa 716



Assa 5816

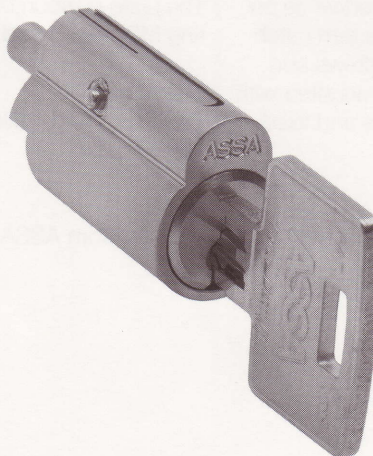

Fix 7310

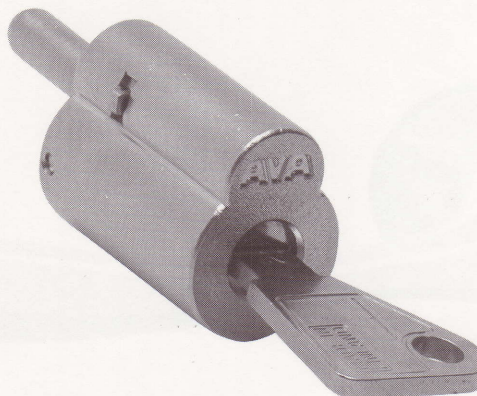

Vinga, accessories

7313
7335
7323
7450

Turn catches Fix 7313 and 7335 fit the inside of handle Fix 7314.

Fix 7335 is specially adapted for the inside of latch bolt espagnolettes Fix S3107 and Fix 4107.

Cover plate Fix 7323 fits the outside of handle Fix 7314.

Operation

The turn catch is pressed from behind into the back plate of handle Fix 7314. The espagnolette is locked when the handle is in a vertical position and unlocked when horizontal.

The cover plate is pressed from behind into the back plate of handle Fix 7314, and used when an outside cylinder is not needed.

Material:

Chrome plated, satin chrome or powder paint coating zamak.

Handle locking device Fix 7450 used for window and glazed door.

Operation

Fix 7450 locks automatically when the handle is turned to locked position. When opening, the catch must be lifted and the handle turned at the same time.

Material

Housing, chrome plated, satin chrome or brass zamak plating.

(Epoxy powder paint and miralloy on order.) Catch arm, galvanized steel.

Installation

In combination with Fix 7311, 7343.

Note:

Type-approved, child-safe.

7450 Type-approved, child-safe

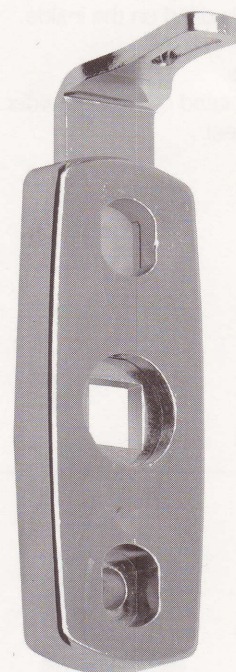

7313

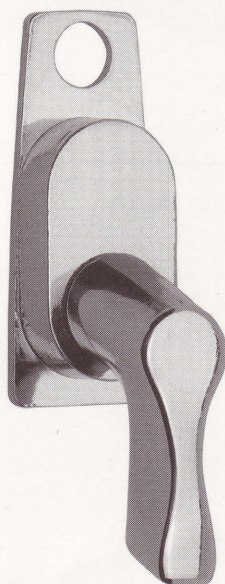

7335

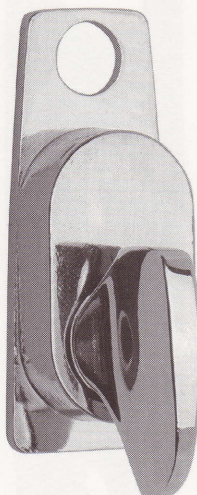

7323

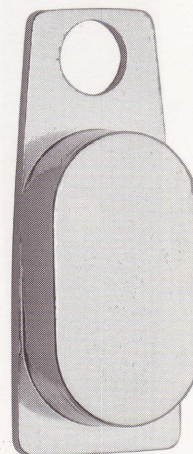

4986
7344
7352

Vinga, accessories

Fixing plate Fix 7352

Used for single sash or coupled sash where only handle Fix 7314 alt. Fix 7315 is used on the inside.

Material:

Chrome plated or white powder paint coated steel.

Spacer plate Fix 7344

Used as a pad for handles Fix 7314 and Fix 7315 when the cylinder sticks out too far.

Construction:

The plate is 10 mm and can be stacked.

Material:

The plate is made of zamak. Polished chrome, satin chrome, brass plated (powder paint and miralloy on request).

Spacer device Fix 4986

Used for cylinder in the Vinga series.

7352



7344

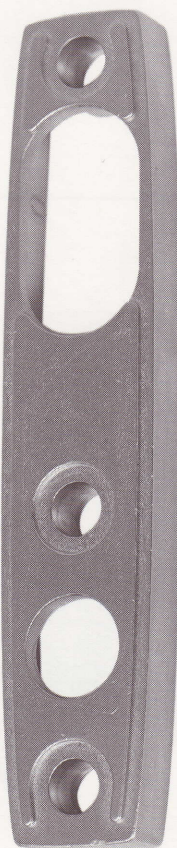

4986

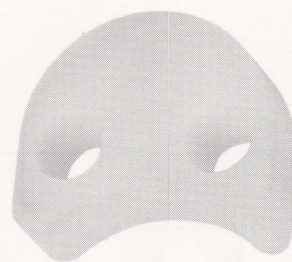

Mounting examples lockable espagnolettes with handle kit Vinga Fix 7314D/7315D suitable for spindle with brake slots (item no. CB90) for single sash.

Cover plate outside. Turn catch inside.

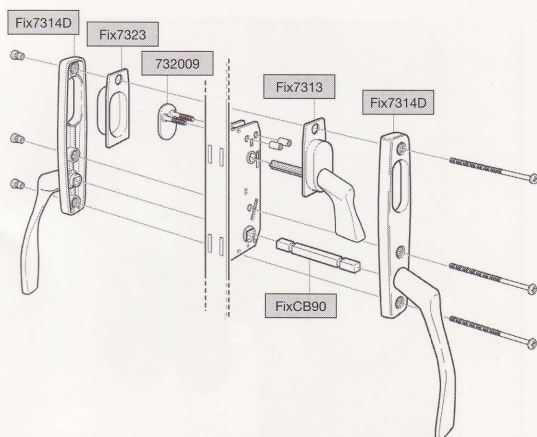

Cylinder both sides.

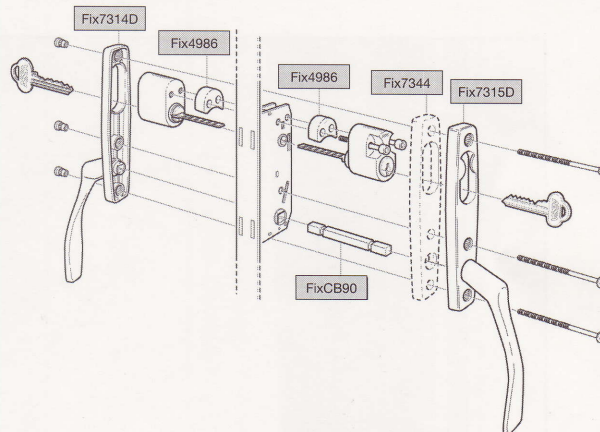

Cover plate outside. Cylinder inside.

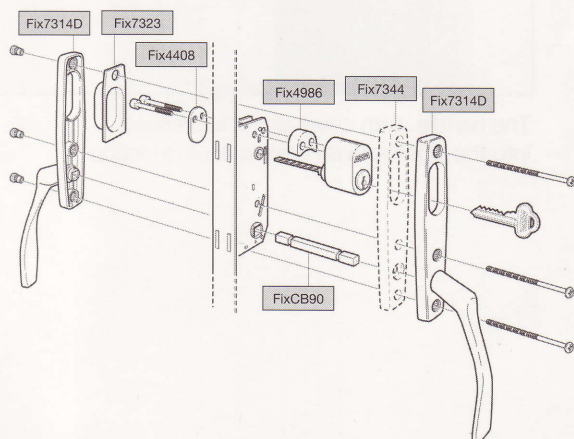

Cylinder outside. Turn catch inside.

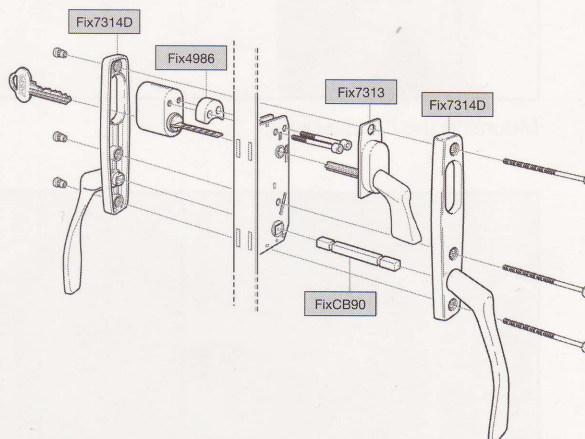

Fixing plate outside. Cylinder inside.

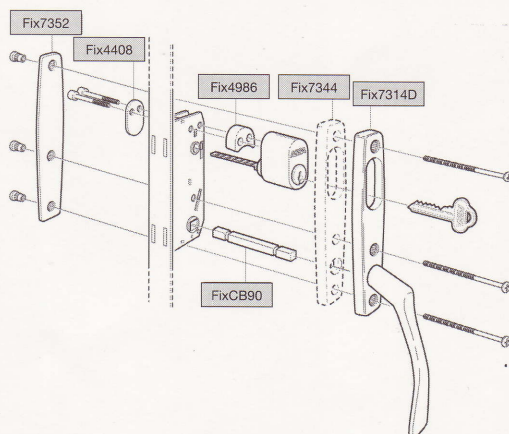

Door thickness

Spindle

49-54	CB90 0800
54-59	CB90 0850
59-64	CB90 0900
64-69	CB90 0950
69-74	CB90 1000
74-79	CB90 1050
79-84	CB90 1100
84-89	CB90 1150
89-94	CB90 1200
94-99	CB90 1250

Vinga, mounting of Vinga handle

The unique snap-in function gives

- easy and quick mounting of the handle
- easy to change the handle

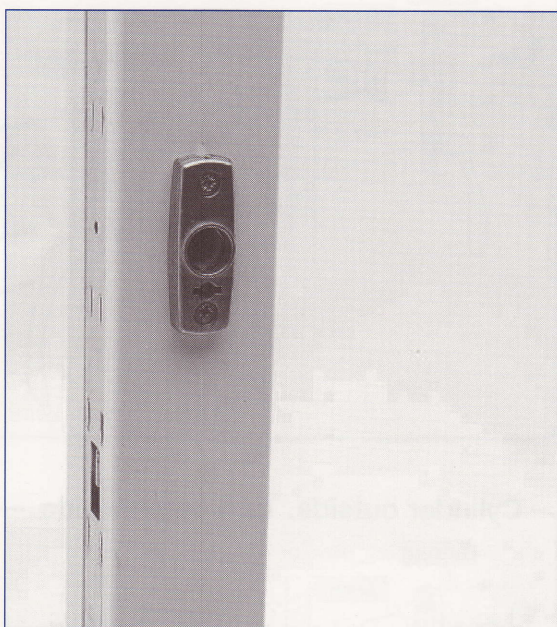

Mounting the handle plate.

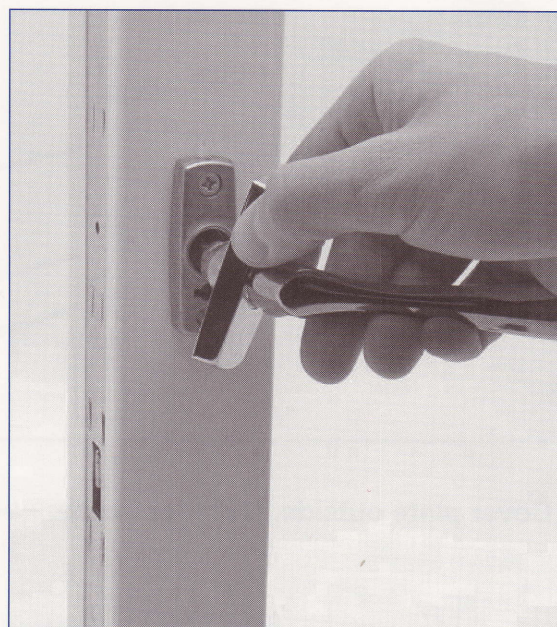

The handle, with cover plate, is pressed into the plate with an easy snap-in function.



The cover plate is pressed into place. Mounting is finished.

Vinga, dismounting of Vinga handle

The unique snap-in function gives

- easy and quick mounting of the handle
- easy to change the handle



The cover plate is loosened and turned.
Dismounting key Fix 7339 is pushed
into the slot in the handle plate.



The handle is pulled out of the plate.

Handle for windows, Fix 98

Available in right and left versions. Used for windows.

Material

Zamak, chrome plated, satin chrome or white powder paint. Spindle of 8 mm galvanized square steel.

Spindle length

38 and 45 mm.

Note

Also available with spindle 7 mm square, handle Fix 97.
Also available with guide pins, Fix 975.

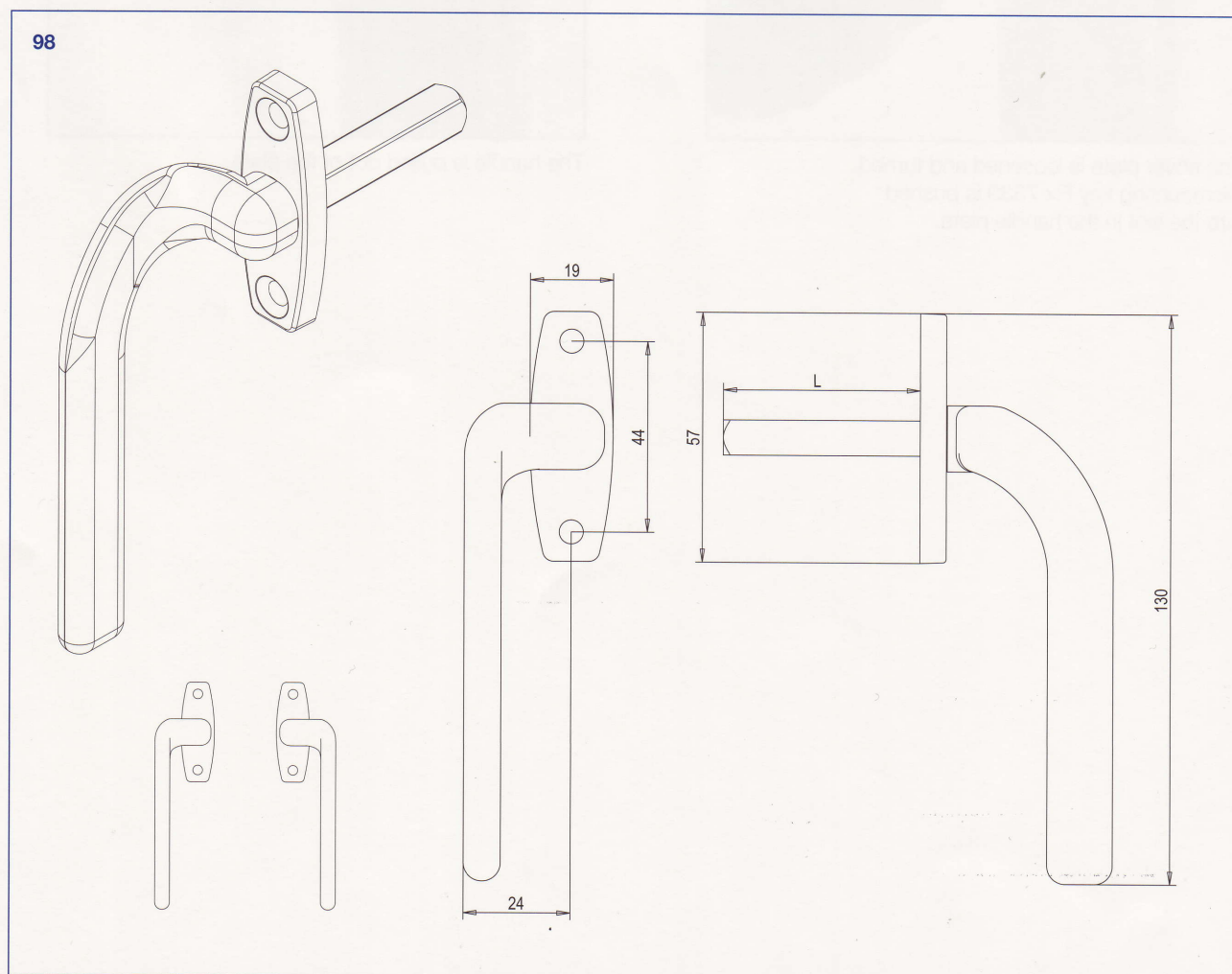

Handles for windows and glazed doors, Fix 83 and 8307

PATENT

Available in right, left and straight versions. Used for windows and glazed doors.

Operation and features

The handle has fixed positions for open and closed, which hold the handle in the right position, not applicable to powder painted type.

Material

Zamak, chrome plated, satin chrome, brass plated or powder painted white or brown. Other colours on request. Fix 83R, H and V are also available in satin brushed brass, w. protective varnish. Item nos. 0083 043M, 0083 H43M and 0083 V43M.

Spindle of 8 mm galvanized square steel.

Spindle length

23, 33, 43, 53, 63 mm.

Accessories

Handle locking devices Fix 840 and 850, page G-143. Handle coupling, page G 137, used when handles are to be mounted on both sides.

Handle 8307

Like Fix 83, but with 7 mm spindle of galvanized square steel.

For handle locking devices Fix 840 and 850 to fit, the spindle is 8 mm closest to the handle plate.

General description, catalogue section B.

Note

Outside handle: for increased corrosion protection, powder painted zamak handle is recommended.

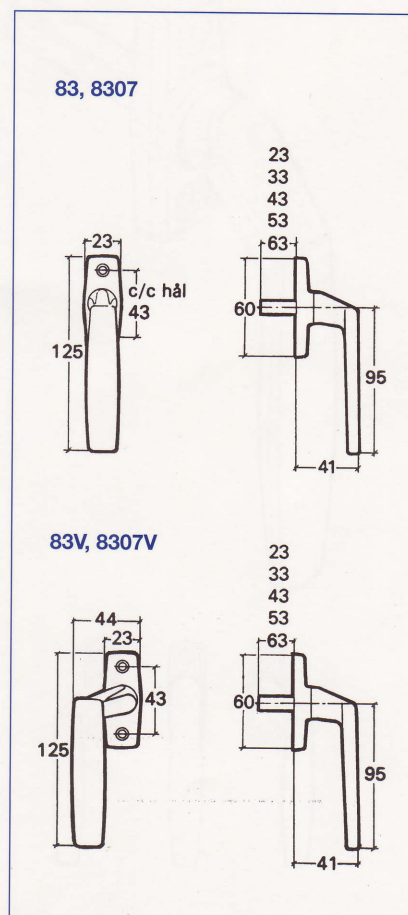
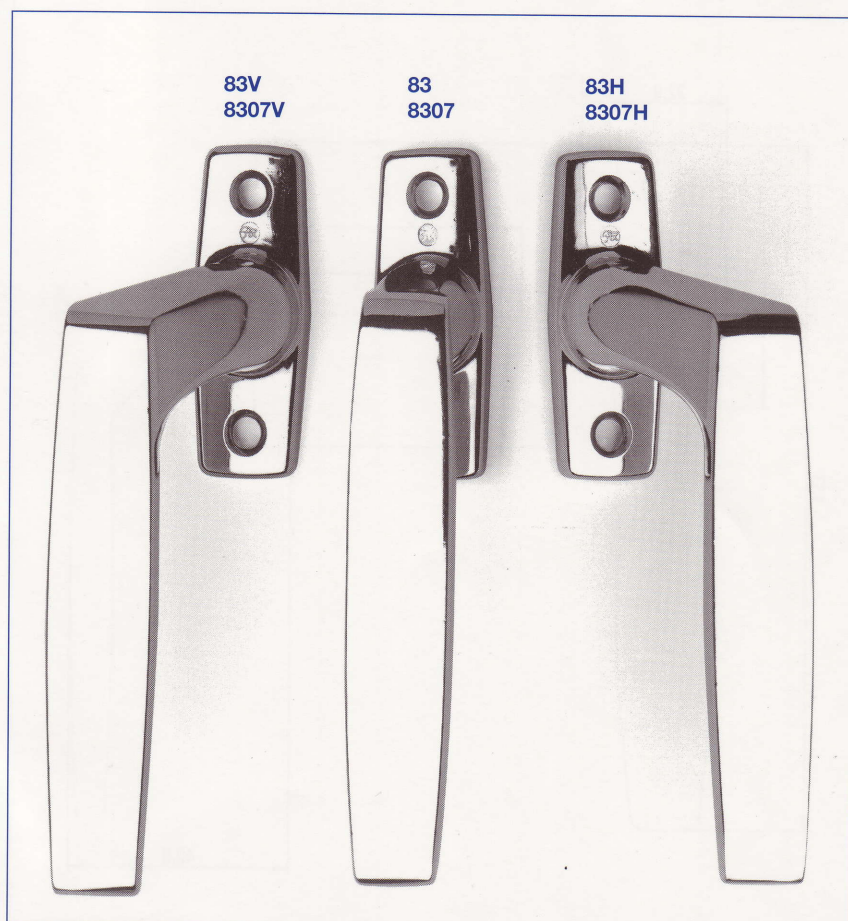

Handle for windows and glazed doors, Fix 2162

Available in right, left and straight versions. Used for windows and glazed doors.

Operation and features

The handle has fixed positions for open and closed, which hold the handle in the right position.

Material

Zamak, chrome plated, satin chrome, white powder paint or brass. Spindle of 8 mm galvanized square steel.

Spindle length

43 and 53 mm.

Accessories

Handle locking devices Fix 2144 and 2145.

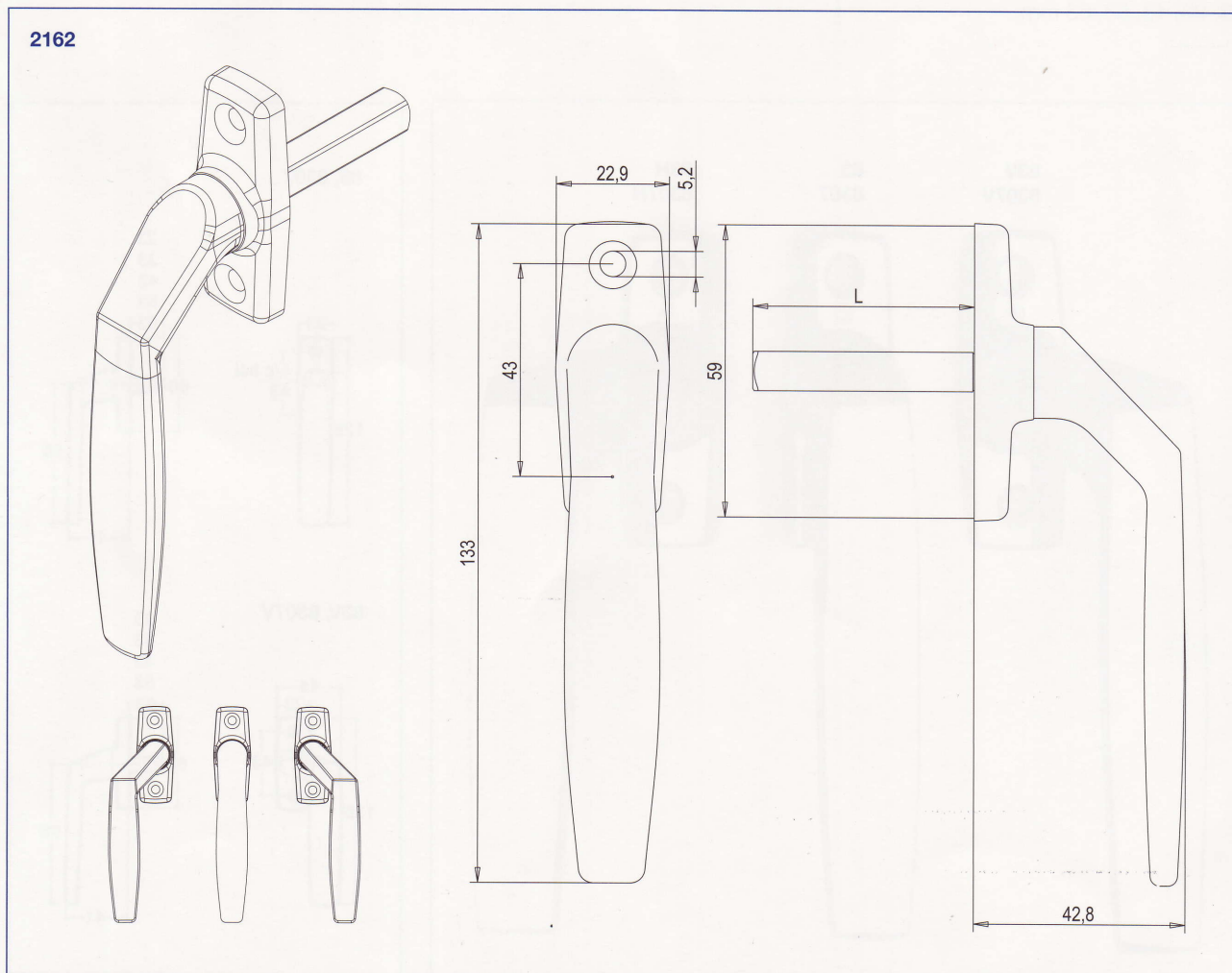

Handles for windows and glazed doors, Fix 42 and 4207

42
4207
833 833/16
961

Handle 42

Available in straight, right and left versions. Used for windows and glazed doors.

Material

Zamak, chrome plated, satin chrome, brass plated or powder painted white. Pin of 8 mm galvanized square steel. Pin length 43, 63 mm.

Accessories

Handle locking devices Fix 840, 850, page G-143.

Handle coupling, see below, used when handles are mounted on both sides.

Handle 4207

Like Fix 42, but with 7 mm spindle of galvanized square steel. For handle locking devices Fix 840 and 850 to fit, the 8 mm spindle is closest to the handle plate. General description, catalogue section B.

Note:

Outside handle: for increased corrosion protection, powder painted zamak or aluminium handle is recommended.

Handle Fix 42 is also available with black knob. Suitable for disabled persons. Item no. 0042 C062.

Handle coupling 833 and 833/16

Used for glazed door with single sash, which should have handles on both sides.

Handle coupling 961

Used for coupled glazed door, which should have handles on both sides.

Operation and features

The handle coupling is an efficient protection against forced entry. The break slot is adapted to make the coupling break if the outside handle is overloaded when the inside handle is locked. The outside handle is then out of order.

Construction

Round casing with break slots and 8 mm square hole with stop pins, which prevent the handle spindles from going past the break slots.

Material

Brass casing. For Fix 961: fixing plate of galvanized steel.

Installation

Fix 833 and 833/16 are placed in the hole drilled for the outside handle pin. Fix 961: The fixing plate is screwed to the outer and inner sash without mortising.

Screw

Use for Fix 961: no. 5 (3.0 mm) TFX / DIN 7997.

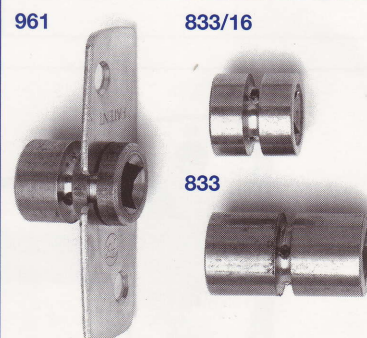

961, 833, 833/16

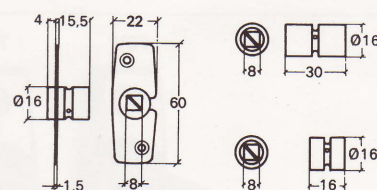

42H, 4207V

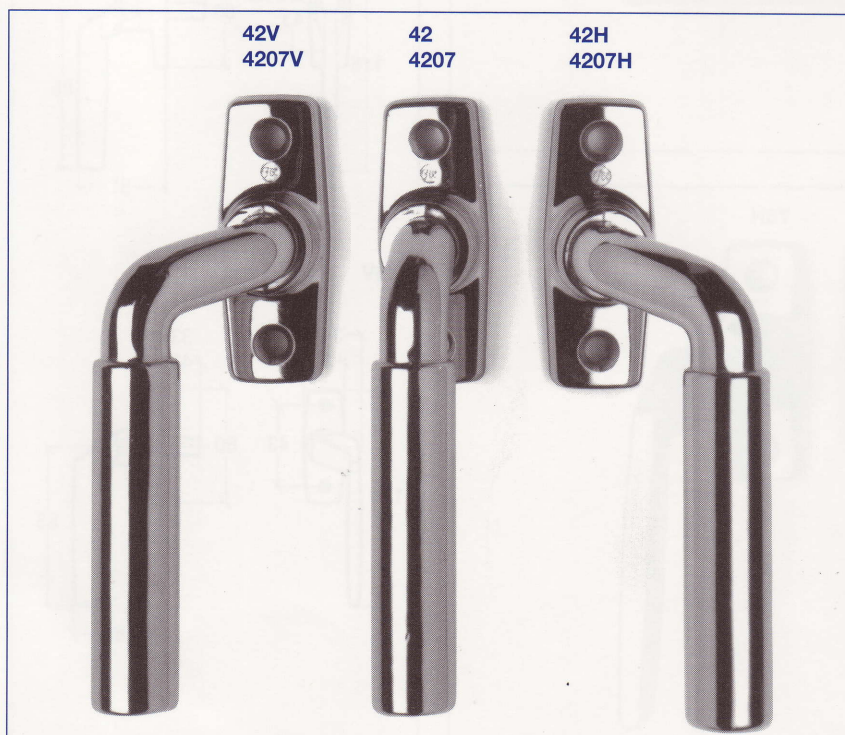
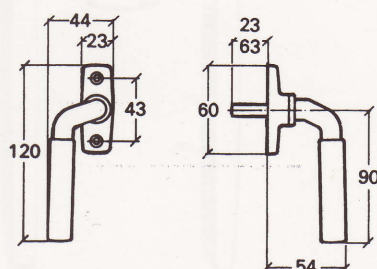

17
76

Handles for windows and doors, Fix 17 and 76

17

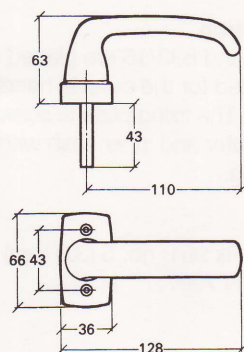

Handle 17

Used for doors with espagnolette for evacuation, page C 26–C 27.

Material

Zamak, chrome plated, powder painted in silver. Miralloy on request.
Pin of 8 mm galvanized square steel.

Spindle length

43 mm.

Operation

In closed position, the handle should be horizontal, where it is held in place by a ball catch.

Screw

Use no. 8 (4.0 mm) TKFX / DIN 7995.

Handle 76

Used for windows.

Available in straight, right and left versions.

Material

Zamak, chrome plated, satin chrome or powder painted white. Other colours on request. Spindle of 8 mm galvanized square steel.

Spindle length

33, 43 mm.

Accessories

Handle locking devices Fix 840 and 850, page G 143.

General description, catalogue section B.

17

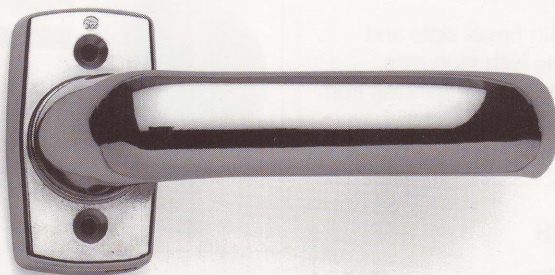

76

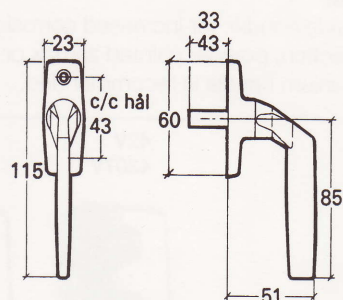

76V

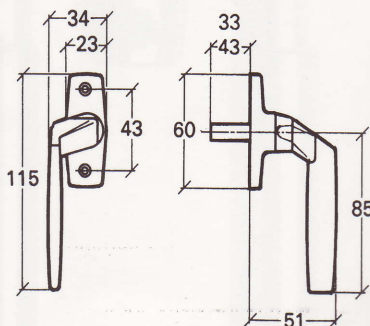

Handles for windows and glazed doors, Fix 95 and 9507

Available in straight, right and left versions.
Used for windows and glazed doors.

Handle 95

Operation and features.

The handle has built-in catch positions for open and closed, which hold the handle in the right position, not applicable to varnished type.

Material

Zamak, chrome plated, satin chrome or powder painted white.

Other colours on request. Spindle of 8 mm galvanized square steel.

Spindle length

23, 33, 43, 53, 63 mm.

Accessories

Handle locking devices Fix 840 and 850, page G 143. Handle coupling, page G 137, used when handles are to be mounted on both sides.

Handle 9507

Like Fix 95, but with 7 mm spindle of galvanized square steel. For handle locking devices Fix 840 and 850 to fit, the spindle is 8 mm closest to the handle plate.

General description, catalogue section B.

Note:

Outside handle: for increased corrosion protection, powder painted zamak or aluminium handle is recommended.

95, 9507

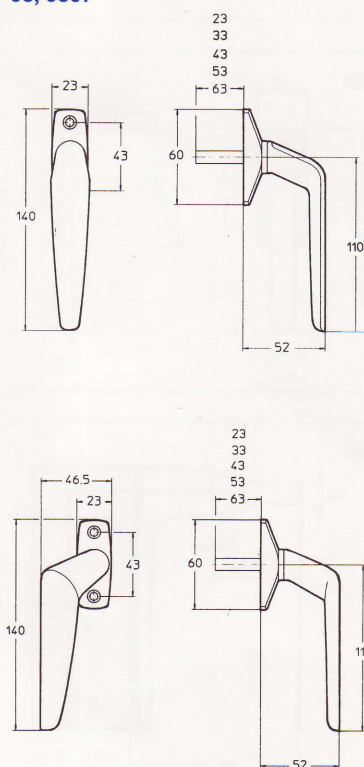

**95V
9507V**

**95
9507**

**95H
9507H**



Handles for windows and hatches

Handle 4

For inward-opening windows and cupboard doors.

Material

Chrome plated zamak. Spindle of 8 mm galvanized square steel. A 7 mm square spindle can be delivered on request.

Spindle length 33 and 43 mm.

Handle 8

Used for outward-opening windows.
Screw: TKFX 4.0 x L / DIN 7995.
Spindle length: 23, 33, 43 and 53 mm.

Operation and features

Narrow handle plate, only 18 mm. Has built-in fixed positions for open and closed, which hold the handle in the right position.
Available in right and left versions.

Material

White, acetal plastic.

Spindle square 7 alt. 8, galvanized steel.

Handle 24

For situations where there is no room for a handle of normal height.

Material

Chrome plated zamak with spindle of 8 mm square galvanized steel.

Spindle length 43 mm.

Handle 51

For windows, doors, hatches, which cannot have a fixed handle, and where there is no risk for spontaneous opening. (In such cases, Fix 805 + 811 is recommended, page G 144.)

Operation and features

Fits in plate Fix 1857, 1857T, page G 142. When turning to open, the stud makes it possible to pull the sash towards you. The handle can only be taken out in closed position.

Material

Chrome plated zamak with spindle of 8 mm square galvanized steel.
Spindle length 33 and 63 mm. General description, page D1.

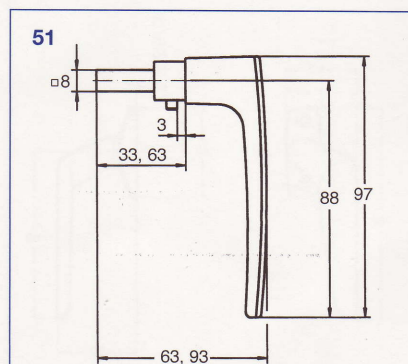
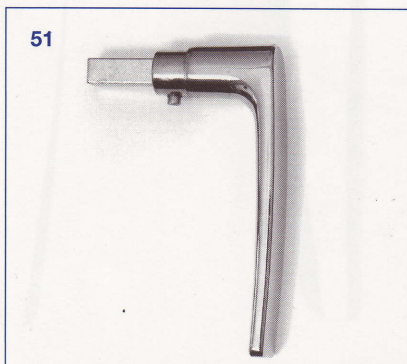
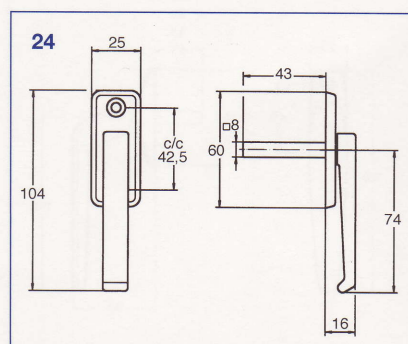
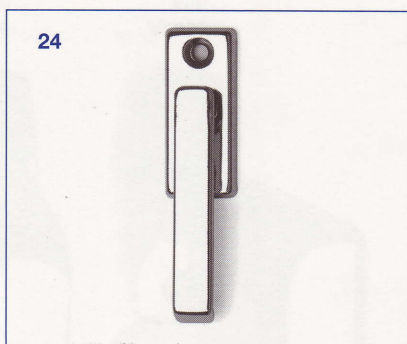
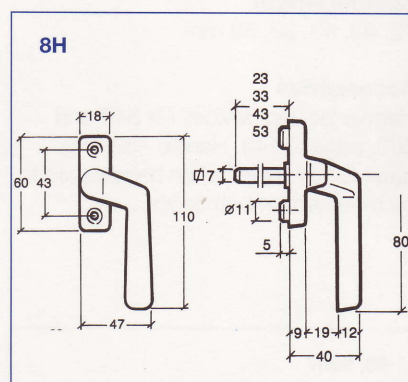
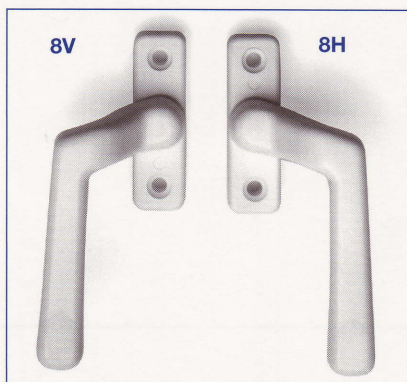
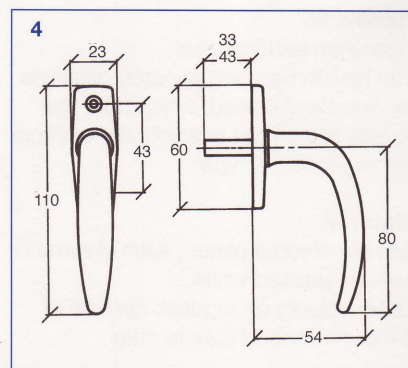
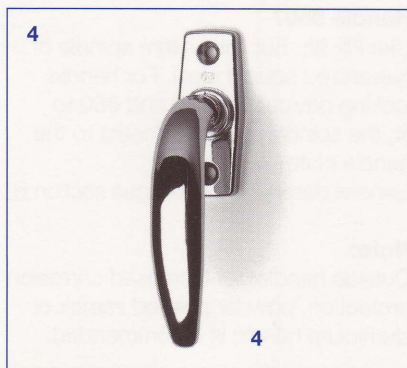

Handles for windows and glazed doors

G210216405
G210216415
G210216425
G210316405
G210316415
G210316425

L design

Handle G210216405, straight

Handle G210216415, right

Handle G210216425, left

U design

Handle G210316405, straight

Handle G210316415, right

Handle G210316425, left

Used for inward- and outward-opening windows or glazed doors.

Screw: TKFX 4.0 x L / DIN 7995.

Pin length: 43 mm.

Features:

Has built-in fixed positions, 90, 135 and 180 degrees, which hold the handle in the right position.

The handle has a cover plate for hidden screw mounting.

Material:

Satin brushed stainless steel.
Spindle, square 7 mm, galvanized steel. Casing for square 8 mm is included.

Accessories:

Handle coupling, page G 137.

G210216415

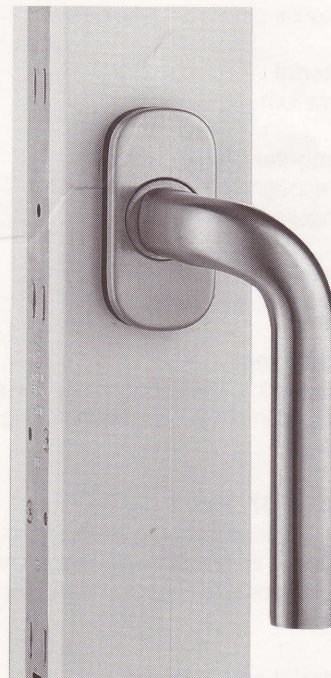

G210316415

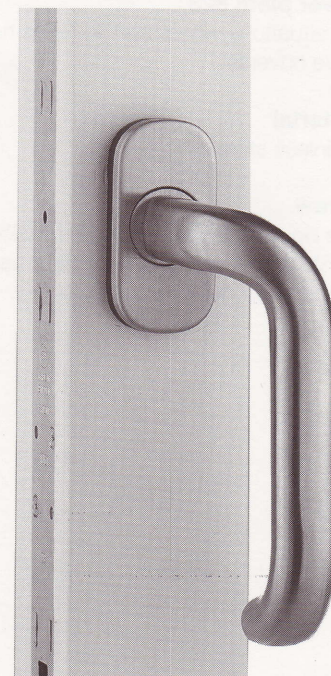

**NOT
AVAILABLE
ANY
LONGER**

145
56
1857
1857T
823

Triangular key, triangular pin, plates

Not recommended where there is a risk of spontaneous opening.
(Use Fix 805 + 811 instead, page G 144)

Triangular key 145

For operation of espagnolettes with triangular pin Fix 56, see below.

Material

Aluminium.

Triangular pin 56

For espagnolette operated with triangular key Fix 145.

Material

Tempered, galvanized steel.

Installation

Mounted into the espagnolette rower and held in place with the matching screw.

Plate 1857, 1857T

For situations involving an espagnolette and dead lock, which is operated with a square handle Fix 51 or triangular key Fix 145.

Material and features

Stainless steel, with cover plate of acetal plastic.

Cover plate 823

For situations where handle holes need to be covered.

Material

Stainless steel.

Screw

Use no. 6 (3.0 mm) TKFX/DIN 7995.
For outside mounting of Fix 823, use the corresponding one-way screw.

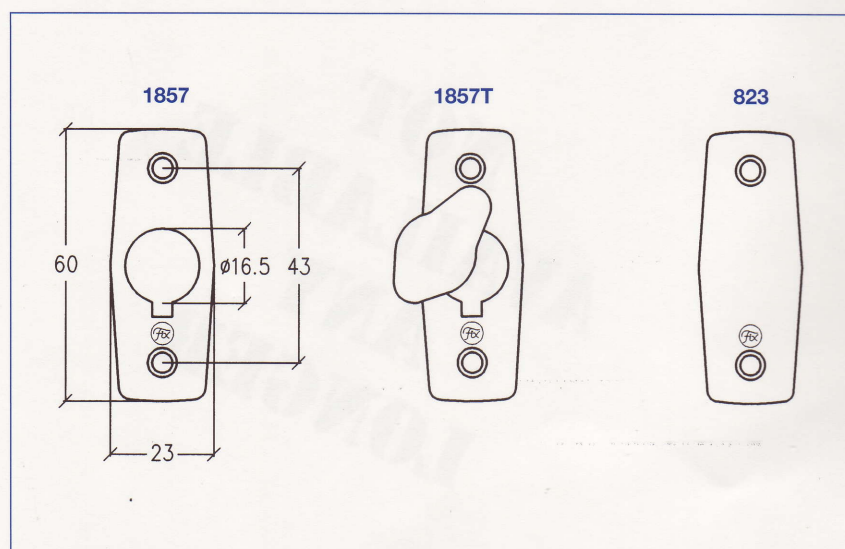
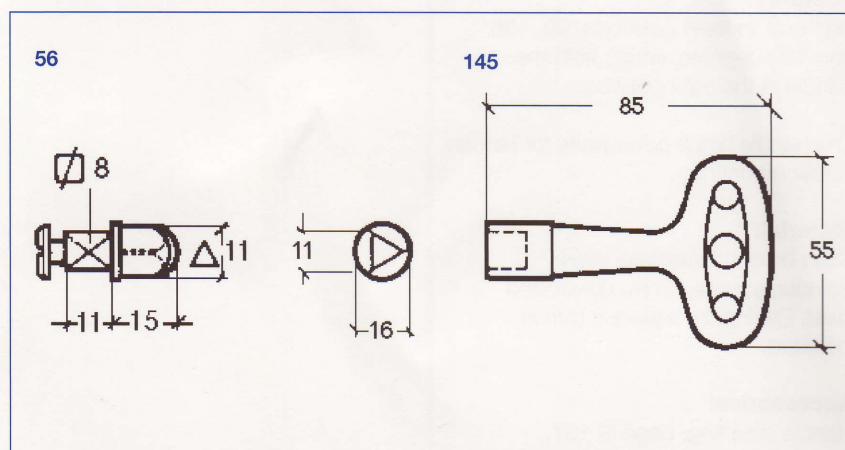
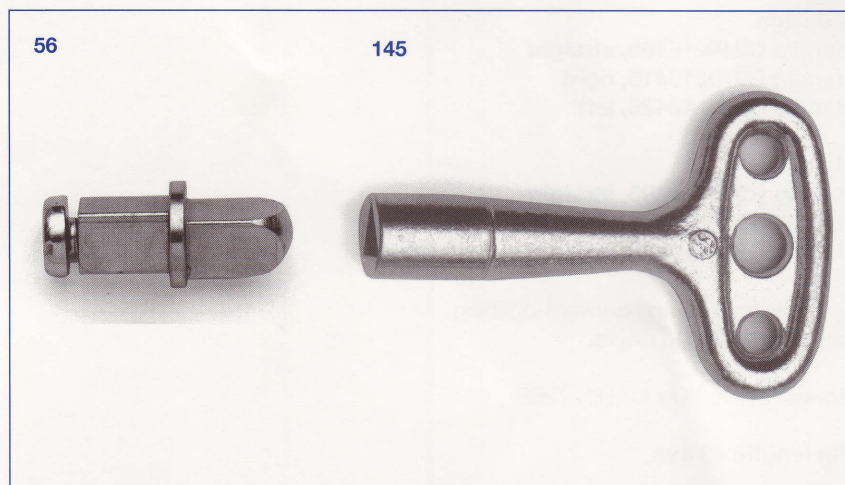

Handle locking devices, Fix 840 and 850, mounting plate, Fix 4285

840
850
4285

Handle locking device 840

For glazed doors with Fix espagnolette handle, which are to be locked on the inside.

Operation and features

Opened and closed manually. Locks in down position.

Handle locking device 850

Type-approved, child-safe lock.
For windows and glazed doors, which should have security fitting according to building regulations outlined by the Swedish National Board of Building, Planning and Housing, BBR94.

Operation and features

Locks the handle automatically when it is turned to locked position.
When opening, the catch must be lifted and the handle turned at the same time.

Material for both

Catch housing of zamak, chrome plated or with acetal plastic cover.
Finger grip of polyamide, white for Fix 850, black for Fix 840.

Mounting plate 4285

For Fix espagnolette handle, which replaces older handle with long plate.

Material

Steel, chrome plated or powder painted, white.

Installation

Mounted on the handle with the matching screw.

840



850 Type-approved, child-safe



840, 850

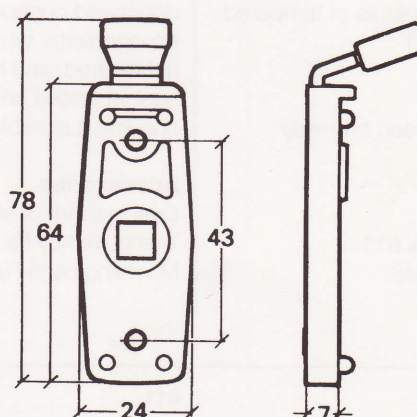

4285
installation

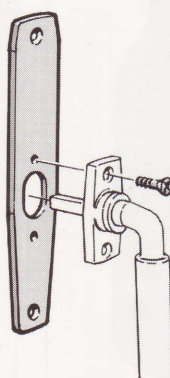

4285

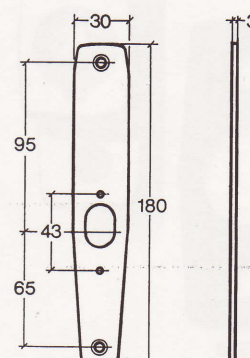

805
4548
811
836S

Security device, triangular handle

Security device 805

Type-approved as child-safe security fitting. Used instead of handle for windows, glazed doors and cupboard doors with espagnolette where child safety against unauthorized opening is required. For example staircases, corridors, hospitals, nurseries, etc.

Operation and features

A spring-loaded catch plate lies around the triangular pin. It must be pushed in to a certain position to enable turning of the spindle and activating the espagnolette.

Material

Catch housing of chrome plated zamak. Spindle and catch plate of tempered, galvanized steel.

Spindle length

23, 33, 43. (Note: spindle of tempered steel, difficult to cut.)

Installation

Mounted with enclosed one-way screws.

Accessories

Triangular handle Fix 811.
Spacer plate Fix 4548.

Spacer plate 4548

Used when mounting is done without drilling for the security device hub.

Material

Grey acetal plastic.

Triangular handle 811

Used for operation of Fix 805.

Operation and features

When the handle is turned, the sash can be pulled with the handle. It can only be taken out in closed position.

Material

Chrome plated zamak.

Security device 836S (self-locking)

Approved according to SS 3620 classification B.

Used for the inside of windows, glazed doors and cupboard doors with an espagnolette, where a fixed handle is not desired, and it needs to be secured against forced entry or unauthorized opening. Lockable with cylinder.

Accessories

Oval cylinder of standard type.
Triangular key Fix 145.
Mounting plate Fix 841S, page G 146.

Spindle length

33, 43, 53 mm.

Otherwise like Fix 837S, page G 145.

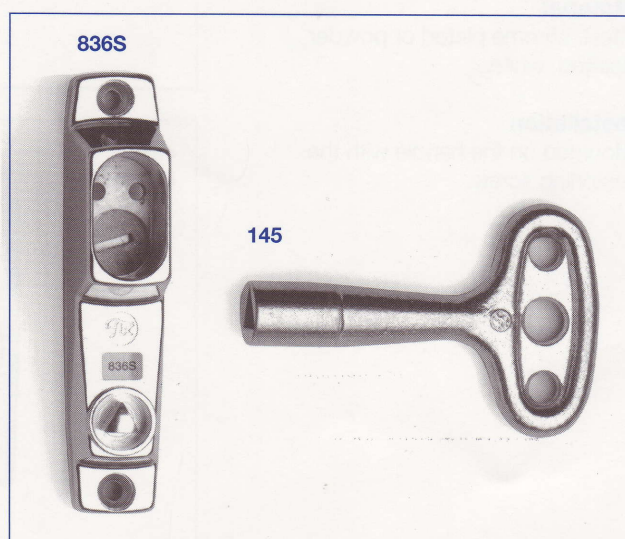
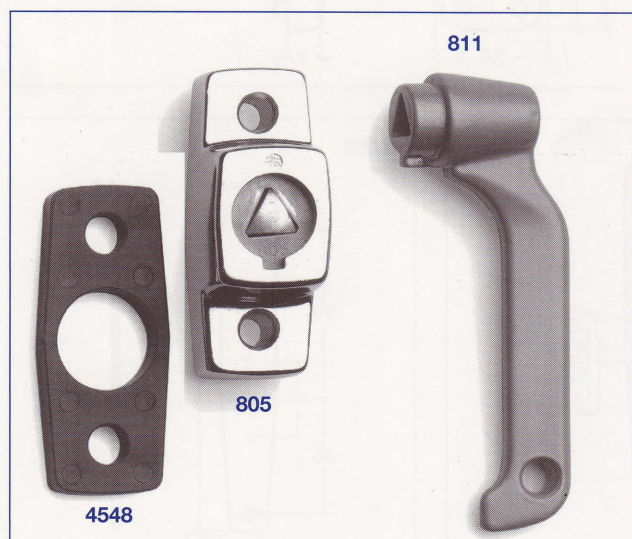
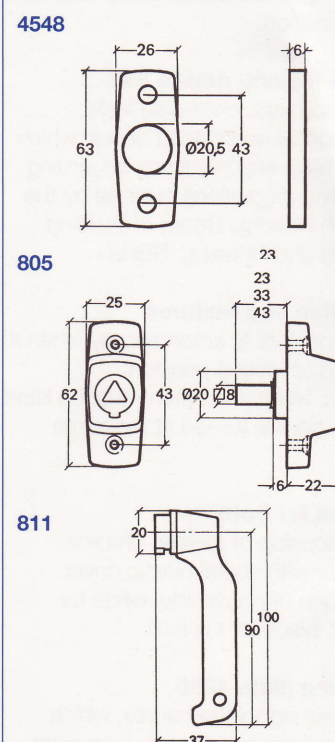

Security handles for windows and glazed doors, Fix 835S and 837S

835S
837S

Approved according to SS 3620 classification B. Available in straight, right and left versions. Lockable with cylinder (not included).

835S and 837S

Used for the inside of windows, glazed doors and cupboard doors with an espagnolette, and which needs to be secured against forced entry or unauthorized opening.

Fix 835S is locked by turning a key. Fix 837S automatically locks when the handle is turned to locked position.

Operation and features

Locking is done with oval cylinder of standard type. The key can be taken out when unlocked.

The handle has a slip coupling (not applicable to handle with 7 mm square spindle), which is operated when overloaded to prevent breaking of the lock mechanism in case of attempted forced entry and unauthorized opening from the inside. When the grip slips, the espagnolette is not activated until

after unlocking. After the grip has been slipping, the security handle must be replaced.

Material

Zamak, chrome plated, satin chrome, brass plated or powder painted white.

Spindle of 8 mm galvanized square steel. A 7 mm square spindle can be delivered on request. However, not available with slip coupling (see Operation and features).

Spindle length

43, 53 mm.

Installation

For single sash, and for coupled sash where the inner sash is at least 35 mm, see illustration 1, page G 146.

For single sash with an older type of

espagnolette, see illustrations 2 and 3, page G 146. Use mounting plate Fix 841S. For coupled sash, where the inner sash is less than 35 mm, see illustrations 4, page G 146. Use fixing plate Fix 5325. For coupled sash with an older type of espagnolette, see illustrations 5 and 6, page G 146. Use mounting plate Fix 841S and fixing plate Fix 5325.

Accessories

Oval cylinder of standard type. Mounting plate Fix 841S. Fixing plate Fix 5325. Handle coupling Fix 833, used when handle should be mounted on both sides. Screw included. Fix 835S is also available with micro switch. Item no. 0835SMB00.

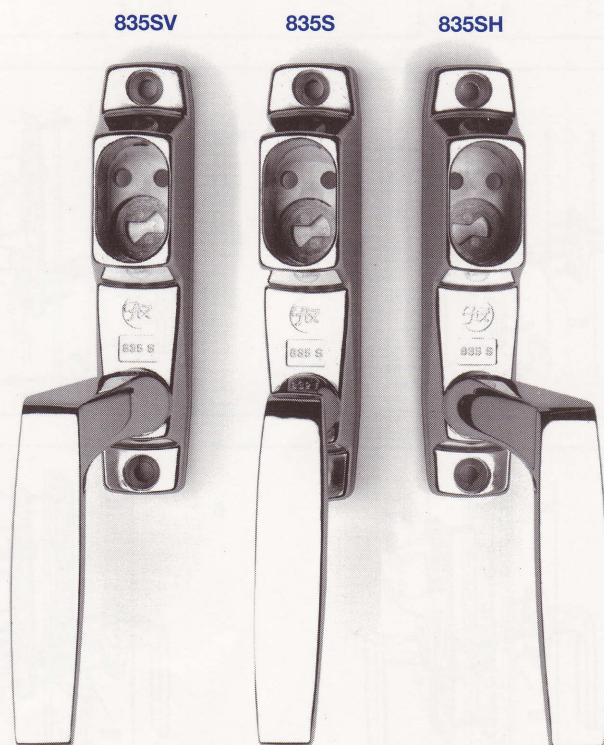

835S

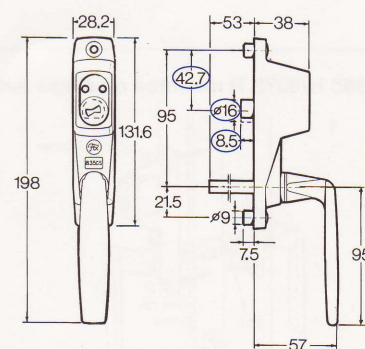

Measurements in  apply to Fix 8350S, page G 147

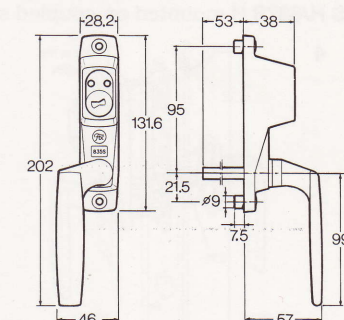

841S
5325
5365

Accessories for security handles

Mounting plate 841S

Used for Fix 835S, 836S, 837S and 8350S for mounting on single sash with an older type of espagnolette.

Material

Steel, chrome plated, brass plated or powder painted white.

Necessary screws included.

Fixing plates 5325 and 5365

Used for mounting on coupled sash:
Fix 5325 for Fix 835S, 836S, 837S.
Fix 5365 for Fix 8350S.

Material

Zamak. Brass follower.

Necessary screws included.

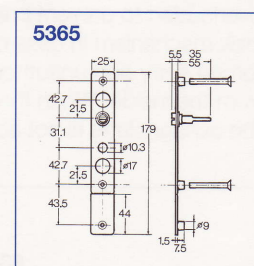
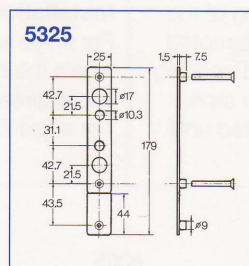
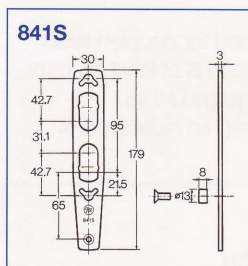
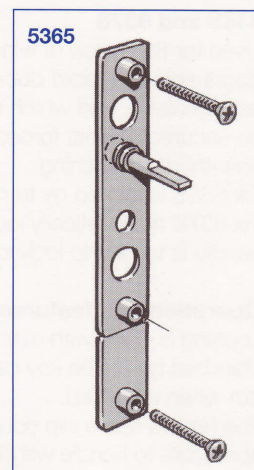
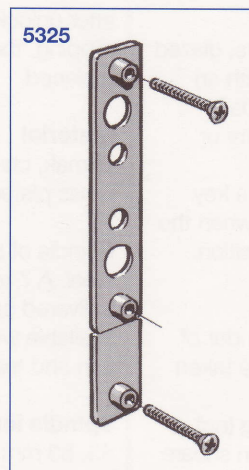
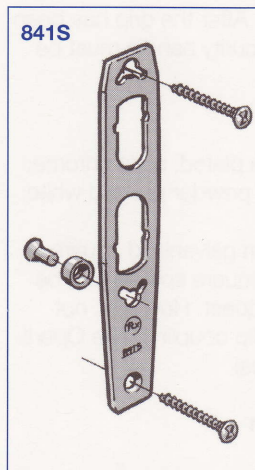

835S H/837S H mounted on single sash

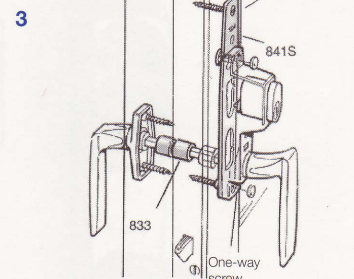
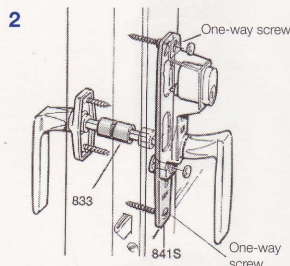
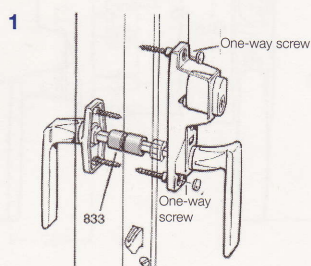

835S H/837S H mounted on coupled sash

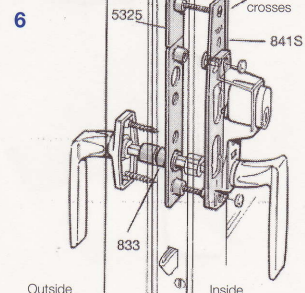
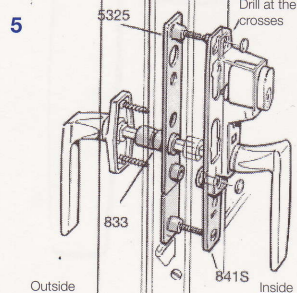
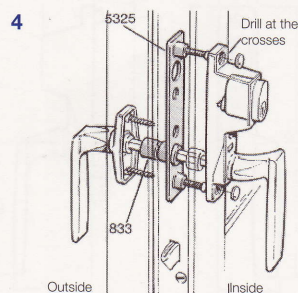

Security handle for windows and glazed doors, Fix 8350S

Approved according to SS 3620 classification B. Available in straight, right and left versions. Lockable with cylinder from both sides (cylinder not included).

Used for the inside of glazed doors, with an espagnolette, which needs to be secured against forced entry or unauthorized opening, and also be lockable from the outside. Non-lockable espagnolette is needed.

Operation and features

Like Fix 835S, page G 145, but is also equipped with a receiver for the driver on the outside cylinder. This enables locking from both sides.

Material and spindle length

Like Fix 835S, page G 145.

Installation

See illustration.

Accessories

Outside handle, page G 135. Mounting plate Fix 841S, page G 146. Handle coupling Fix 833, 833/16, page G 137. Oval cylinder of standard type.

Otherwise for coupled sash:

Fixing plate Fix 5365, page G 146.

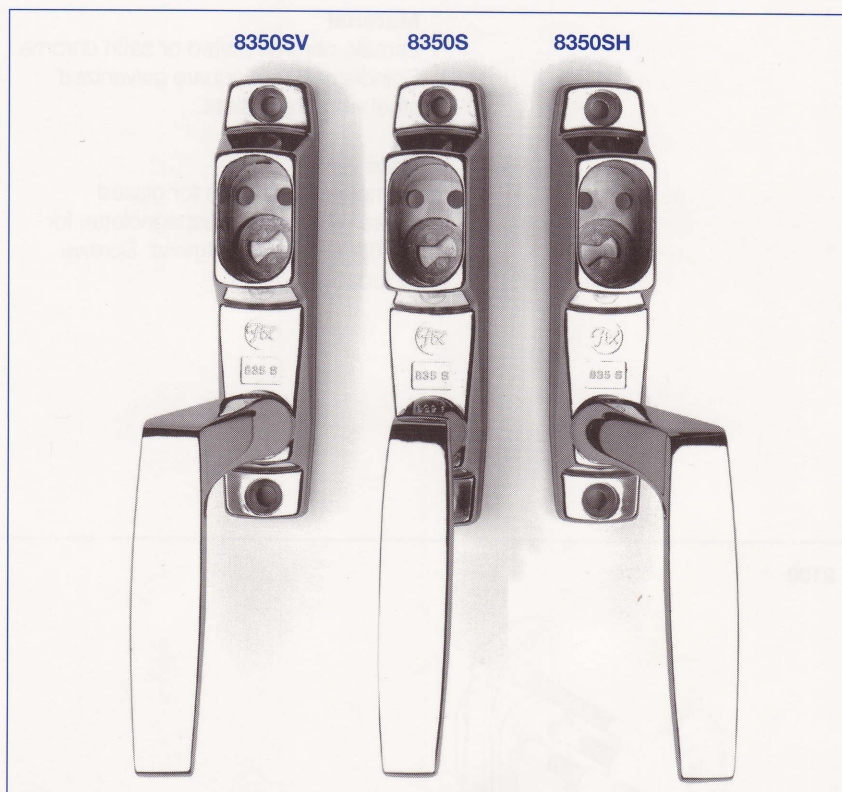

8350SH mounted on coupled door

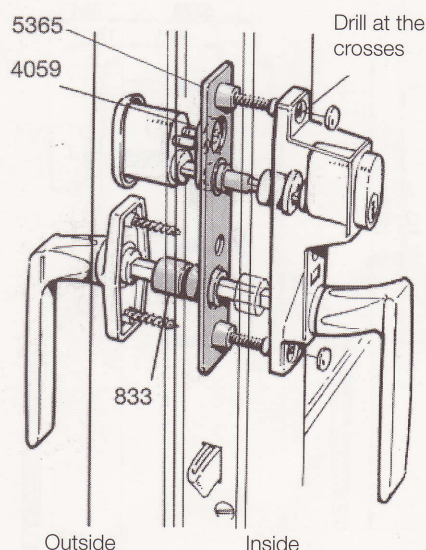

8350SH mounted on single door

The outside cylinder is mounted first. Then, the driver is fitted into the handle receptacle, and the handle screws are tightened.

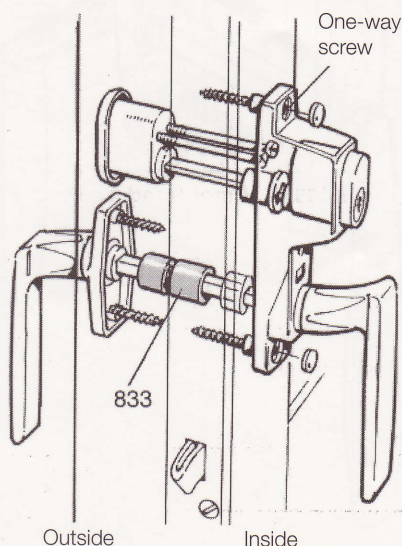

Handle kit for glazed doors, with lockable espagnolettes, Fix 2130

Including right and lefthand version. Used for outward-opening glazed doors.

Material

Zamak, chrome plated or satin chrome.
Spindle of 8 mm square galvanized steel with break slots.

Note

Complete back plate for glazed doors with lockable espagnolette, for 53–68 mm door thickness. Screws included.

2130

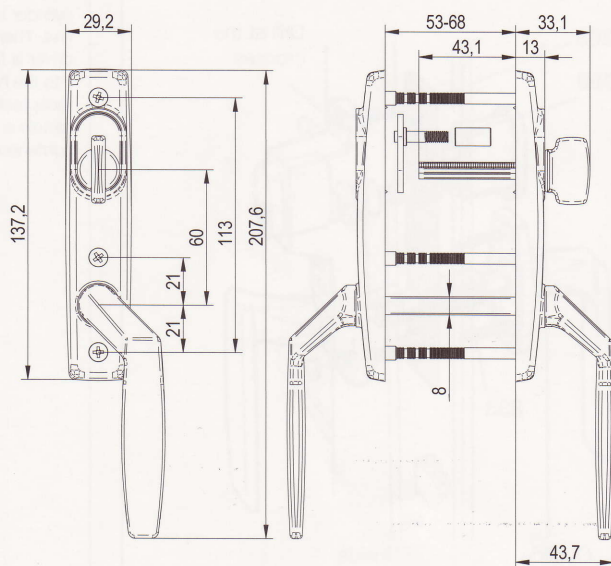
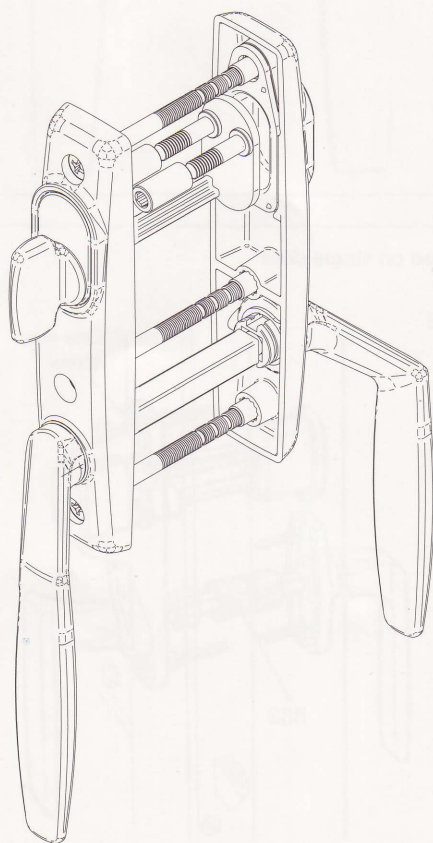

Handles for pivot-hung windows, top-hung or glide-hung

2265
2265S
8350
8465S
2384

Handle 2265

The handle has a ventilation tongue for opening the sash in small, fixed airing positions. Can be made child-safe in both airing and closed positions using handle locking device Fix 850.

Material

Zamak, chrome plated or satin chrome.

Spindle of 8 mm galvanized square steel. Spindle length 35, 43, 53 mm.
General description, catalogue section B.

Security handle

2265S8350 and 8465S

Approved according to SS 3620 classification B.

Both handles have a ventilation tongue for opening the sash in small, fixed airing positions. The handles can be locked in both airing and closed positions

Operation, features and accessories

Fix 835S/65: like Fix 835S, page G 145.
Fix 8465: like Fix 844S, page G 150.
Material Zamak, chrome plated or satin chrome.

Spindle of 8 mm galvanized square steel. Spindle length 53 mm. General description, catalogue section B.

Accessories

Receiver 2384

Material

Grey amide plastic, screw no. 5 TF.

2265

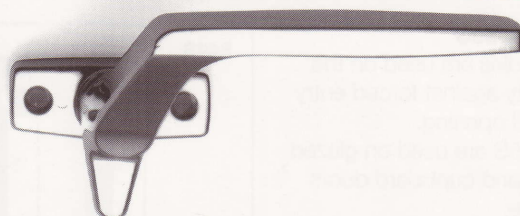

2265

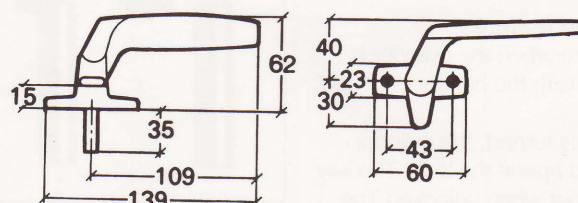

2265S8350

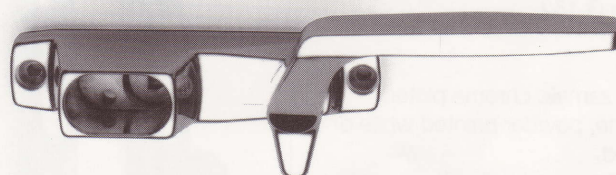

8465S

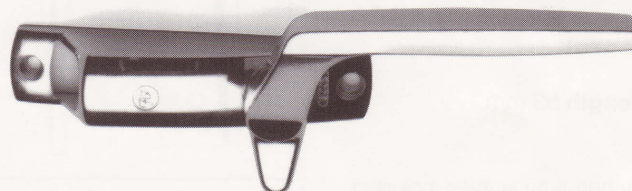

835S8350

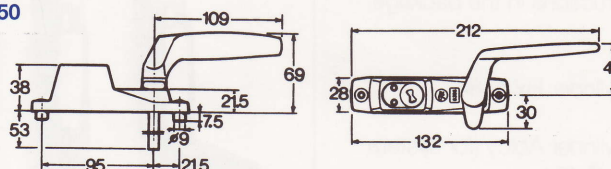

8465S

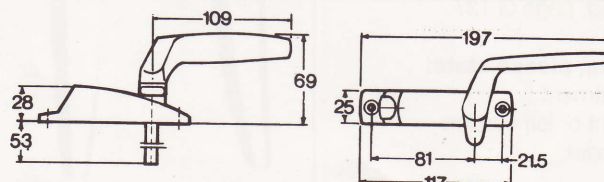

2384

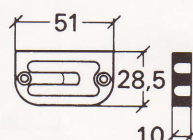

844S
876S
895S

Security handles

Approved according to SS 3620 classification B. Available in straight, right and left versions. Lockable with pushbutton cylinder Fix 4484 and 4482, page D17 (bought separately).

844S, 876S and 895S

The security handles are used on the inside, for security against forced entry and unauthorized opening.

Fix 844S and 895S are used on glazed doors, windows and cupboard doors with espagnolette.

Fix 876S is used on windows and cupboard doors with espagnolette.

Operation and features

Locking is done when the cylinder is pushed down with the handle in closed position.

When the key is turned, the cylinder springs up and opens the lock. The key can be taken out when unlocked. The handles are available with keyed-alike or different locking, and with the same locking as window lock Fix 2820 and 2830, page G 152.

Material

Handles of zamak, chrome plated, satin chrome, powder painted white or brass plated.

Spindle of 8 mm galvanized square steel.

A 7 mm square spindle can be delivered on request.

Spindle length 53 mm.

Screw

Necessary one-way screws included.

Installation

Mounting instructions in the package.

Accessories

Pushbutton cylinder Fix 4484, page G 151.

Pushbutton cylinder Abloy (for system locking), page G 151.

Mounting plate Fix 4926, page G 151.

Handle coupling, page G 137.

When ordering, please state:

1. Surface treatment
2. Straight, right or left version.
3. Type of cylinder.

844S



844S

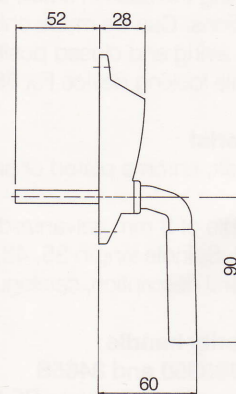

876S



876S

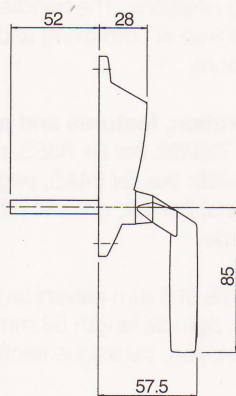

895S



895S

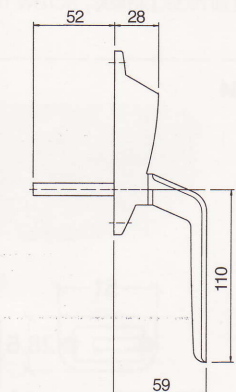

Accessories for security handles

4926
4484
4919

Mounting plate 4926

For security handles Fix 844S, 876S, 895S and 8465S.

When mounting on espagnolettes where the screw hole distance of the handle is insufficient.

Material

Steel, chrome plated or powder painted, white.

Pushbutton cylinder 4484

Cylinder with 9 discs, for security handles Fix 844S, 876S, 895S and 8465S. Also available with the same locking as pushbutton cylinder Fix 7287 intended for window locks Fix 2820 and 2830, page G 152. Two keys Fix 5525 come with each cylinder.

Pushbutton cylinder Abloy

(Ordered from ASSA AB)

Cylinder with 11 discs, for security handles Fix 844S, 876S, 895S and 8465S. Also available with the same locking as pushbutton cylinder intended for window locks Fix 2820 and 2830, page G 152. Also available in systems.

Two keys come with each cylinder.

Material

Cylinders of nickle plated brass with keys of nickle plated steel.

Installation

The cylinder is delivered separately for mounting according to the instructions included with the security handle.

When ordering, please state:

Locking number, alternatively keyed-alike or different locking.

For pushbutton cylinder Abloy in system, please state:

1. Quantity of each lock.
2. New system or supplement to existing system.
3. Number of keys for each lock, and number of master keys.

4926 Mounting example

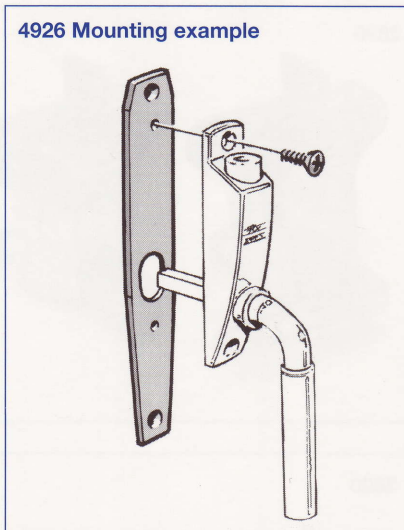

4926

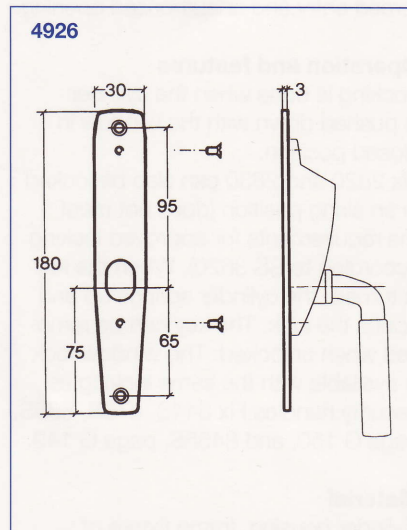

4484

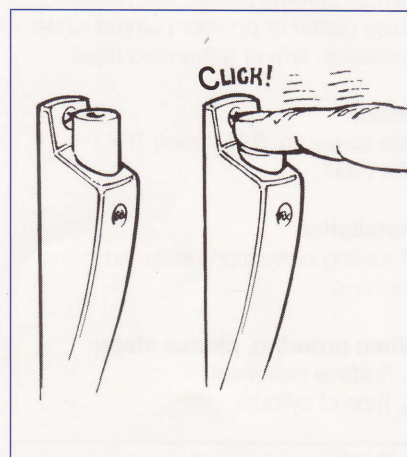

Pushbutton cylinder Abloy



Pin 4919 for pushbutton cylinder 4484

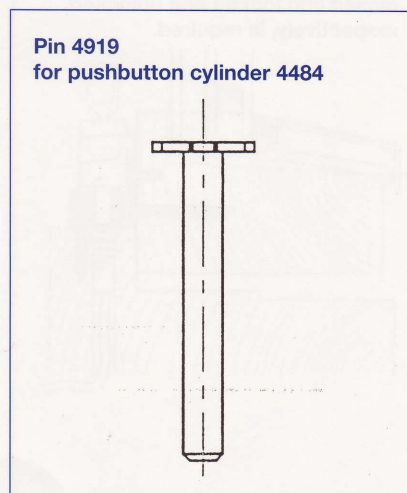

2820
2830
2830E

Window locks, Fix 2820 and 2830

Approved according to SS 3620 classification A. Lockable with pushbutton cylinder Fix 7287 or pushbutton cylinder Abloy.

Used for windows to be secured against forced entry and unauthorized opening.

Operation and features

Locking is done when the cylinder is pushed down with the window in closed position. Fix 2820 and 2830 can also be locked in an airing position (does not meet the requirements for approved locking according to SS 3620). When the key is turned, the cylinder springs up and opens the lock. The key can be removed when unlocked. The window lock is available with the same locking as security handles Fix 844S, 876S, 895S, page G 150, and 8465S, page G 149.

Material

Cylinder housing, frame fixture of zamak, chrome plated, satin chrome, brass plated or powder painted white. Ventilation arm of galvanized steel.

Screw

Use screw no. 8 (4.0 mm) TFX / DIN 7997.

Installation

Mounting instructions included in the package.

When ordering, please state:

1. Surface treatment
2. Type of cylinder

2830E, where an indication for closed and locked and unlocked, respectively, is required.

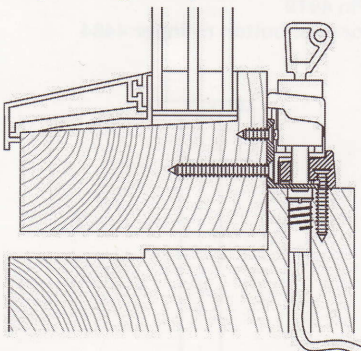

2820

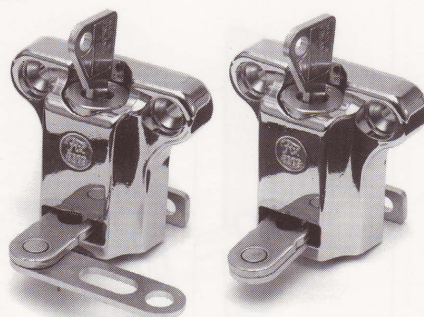

2830



2820

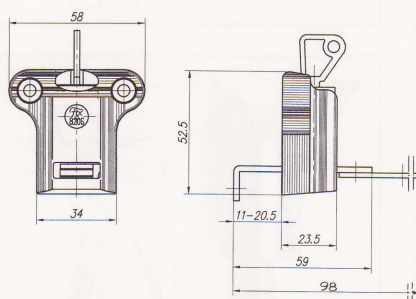

2830

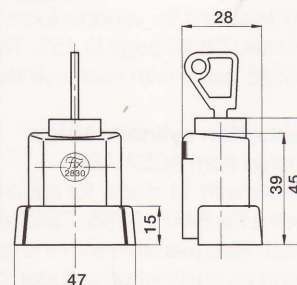

Mounting example 2820

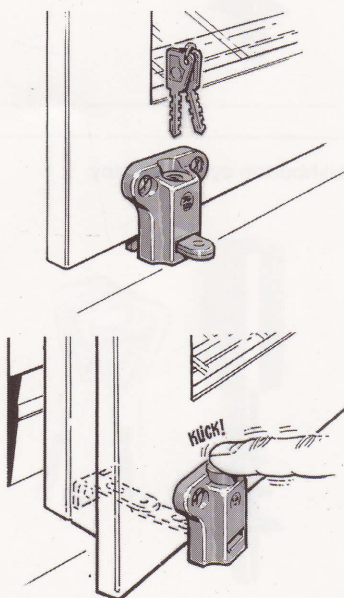

Mounting example 2830

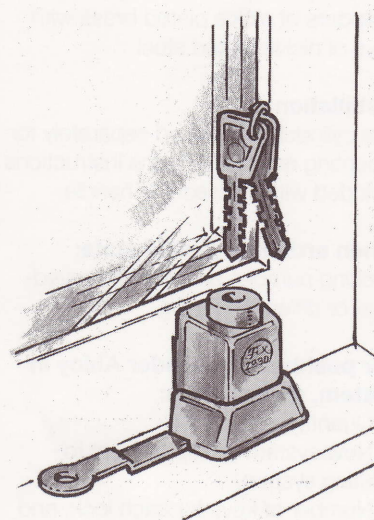

Pushbutton cylinders for window locks, Fix 2820 and 2830

Pushbutton cylinder 7287

Cylinder with 9 discs, for Fix 2820 and 2830. Available with the same locking as pushbutton cylinder Fix 4484 intended for security handles Fix 844S, 876S, 895S and 8465S, page G 149–G 150.

Two keys Fix 5525 come with each cylinder.

Pushbutton cylinder Abloy

(Ordered from ASSA).

Cylinder with 11 discs, for window locks Fix 2820 and 2830. Available with the same locking as pushbutton cylinder intended for security handles Fix 844S, 876S, 895S and 8465S, page G 149–G 150. Also available in system. Two keys come with each cylinder.

Material

Cylinders of nickle plated brass with keys of nickle plated steel.

Installation

The cylinders are delivered separately for mounting according to the instruction included with the window lock.

When ordering, please state:

Locking number, alternatively keyed-alike or different locking.

For pushbutton cylinder Abloy in system, please state:

1. Quantity of each lock.
2. New system or supplement to existing system.
3. Number of keys for each lock, and number of master keys.

7287

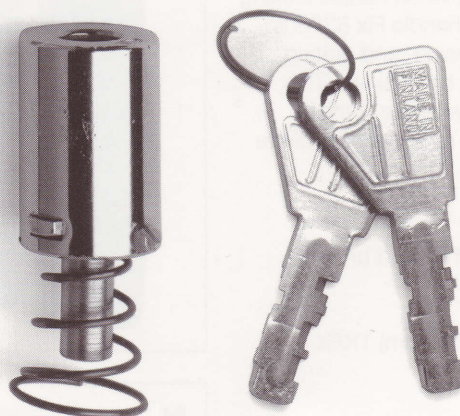

Pushbutton cylinder Abloy

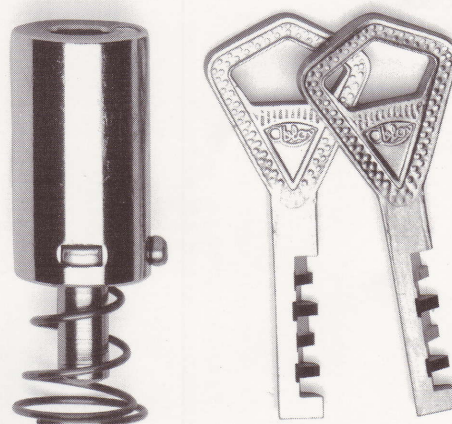

34
94

Pull handles, Fix 34 and 94

Pull handle 34

For the outside of glazed doors.
Especially suitable when handle locking device Fix 850 or handle Fix 837S is mounted on the inside, and getting locked out should be avoided. The plate has the same measurement and hole distance as Fix espagnolette handles.

Material

Acetal plastic in white and brown.

Screw

Use screw no. 8 (4.0 mm) TKFX / DIN 7995.

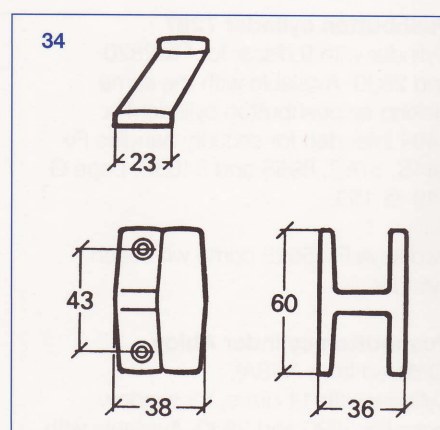
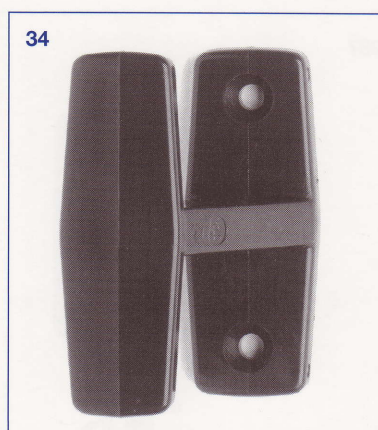

Pull handle 94

For overhead garage doors (up and over), doors to storage or garbage rooms, etc.

Material

Acetal plastic in black.

Screw

Use screw no. 14 (6.0 mm) TKX / DIN 7996.

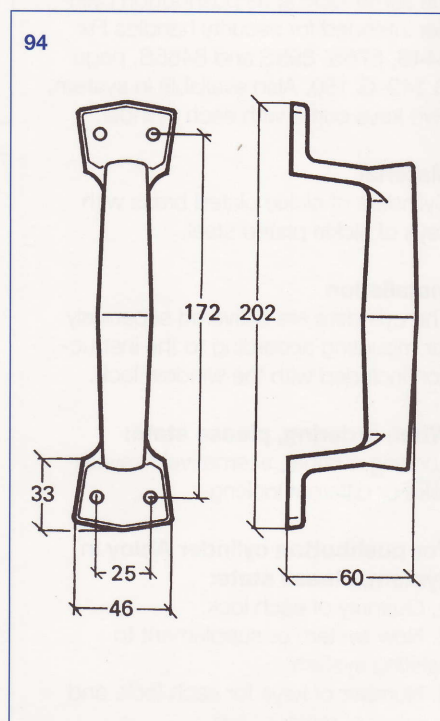

Door Guard, Fix 7500

7500

Security lock for glazed doors. Also available with magnetic indication.
Approved according to SS 3620 classification B, and SS 3535 classification 3.

Door Guard 7500

Used for outward-opening glazed doors.

Lock housing: Surface mounted.
Side bolt: Hook bolts, 2 pcs, Bolts stroke 25 mm. Right/left.

Operation and features:

Lockable with pushbutton cylinder.
Locking with pushbutton cylinder from the Fix Vinga series operates two strong hook bolts, which catch the angled receiver in the frame.

Material:

U profile and hook bolts of steel.
Cover plate of white or brown powder plated or satin chromated sheet metal.
Cylinder housing of polished, chrome plated zamak. Stainless steel support.

Accessories

Assa 716, Vinga cylinder in Assa 700 series.
Assa 5616, Vinga cylinder in Assa Max series.
Assa 4816, Vinga cylinder in Assa 4800 series.
Assa 5816, Vinga cylinder in Assa 5800 series.
Fix 7310, Vinga cylinder Fix.

Installation:

Door Guard is mounted on the inside of the door with penetrating screws.
It is easy to mount the product on an existing door to make it very difficult to force the door and prevent unauthorized opening from the inside.

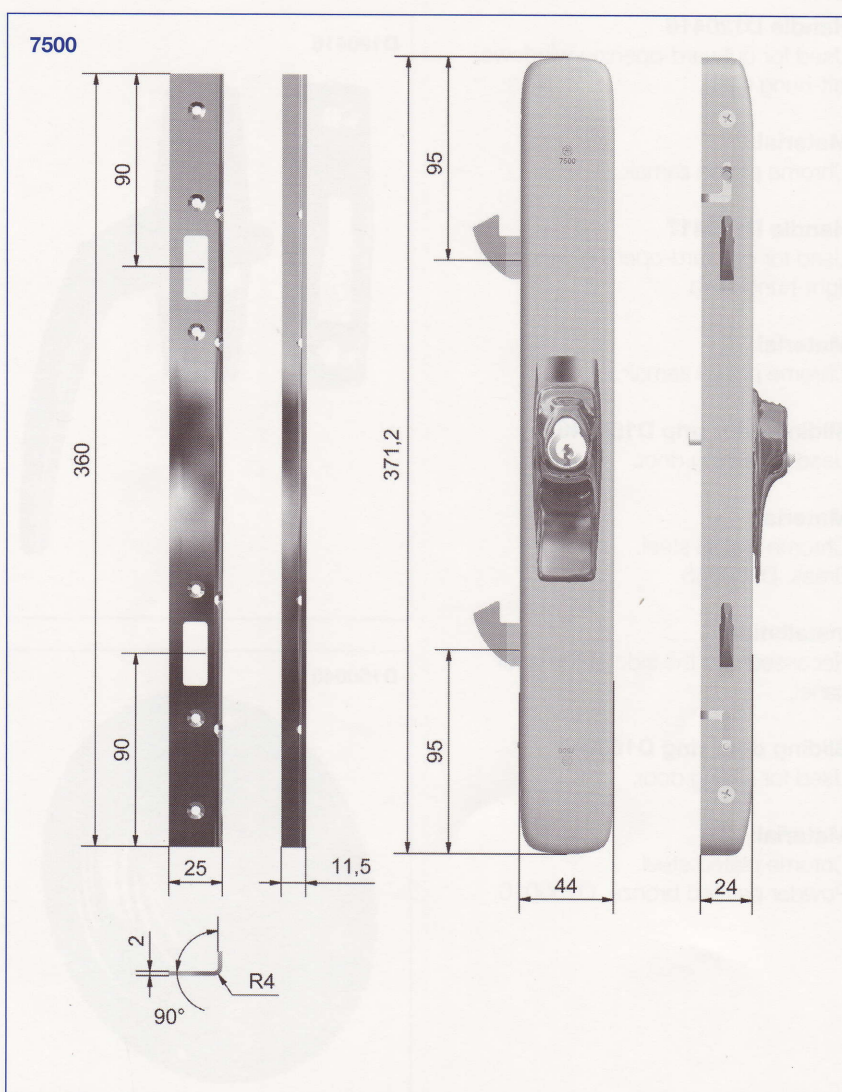

Assa 716



Assa 5816



Fix 7310

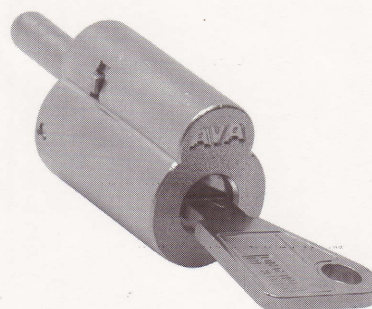

D120416
D120417
D150046
D150045
D150043
D150016

Handles for windows and sliding doors

Handle D120416

Used for outward-opening windows, left-hung sash.

Material:

Chrome plated zamak.

Handle D120417

Used for outward-opening windows, right-hung sash.

Material:

Chrome plated zamak.

Sliding door grip D150046

Used for sliding door.

Material:

Chrome plated steel.
Brass, D150045.

Installation:

Recessed into the side of the door panel.

Sliding door ring D150043

Used for sliding door.

Material:

Chrome plated steel.
Powder painted bronze, D150016.

D120416

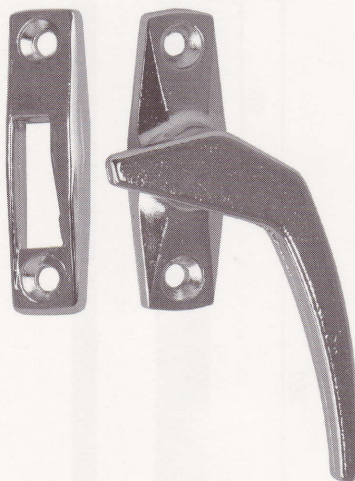

D120417

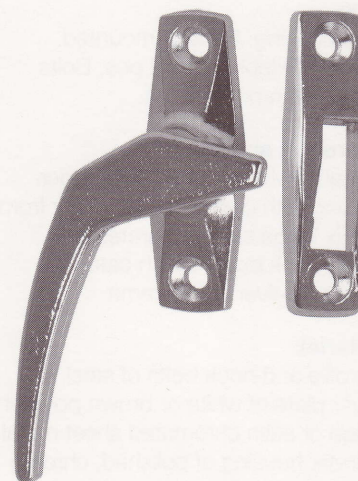

D150046

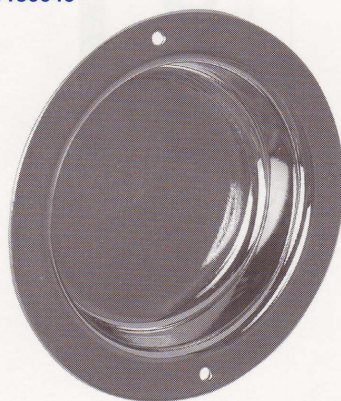

D150043

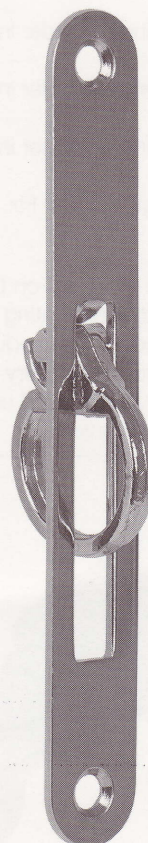

Window closers and receivers for inward-opening windows

23
70
338D
337
77D

Used for inward-opening windows.

Window closer 23

Used for inward-opening windows.

Screw:

TKFX 3.0 x L / DIN 7995.

Material:

Chrome plated zamak.

Window closer Fix 70

Used for inward-opening windows.

Screw: TKFX 3.5 x L / DIN 7995.

Material:

White or black acetal plastic.

Installation:

Surface mounting.

Receiver 338D and 337

Fix 338D for sash lipped over frame in single-light windows and for sashes lipped over frame in two-light windows with a mullion when both windows have window closers. Fix 337 for unlipped sash in single-light windows. Screw: TKFX 3.5 x L / DIN 7995.

Construction:

Fix 338D is available in three heights depending on lipping thickness. See measurement drawing.
25 mm height, lipping thickness 14 mm.
27 mm height, lipping thickness 17 mm.
30 mm height, lipping thickness 19 mm.

337

Used when the lipping thickness is 0 mm.

Material:

Chrome plated profile brass.

Installation:

Surface mounting.

Receiver 77D

Used for inward-opening windows with top-folded frame in single-light windows with mullion, when the sashes have a window closer.

Screw: TKFX 3.5 x L / DIN 7995.

Construction:

Continuous adjustment from 27 to 34 mm height, see measurement drawing. The measurement corresponds

to the top lipping, incl. draught excluders from 12 to 19 mm.

Material:

White or black acetal plastic.

Installation:

Surface mounting.

23

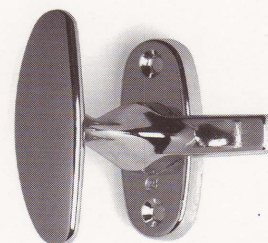

338D



337



70

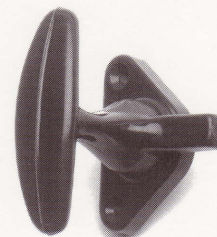

77D



23

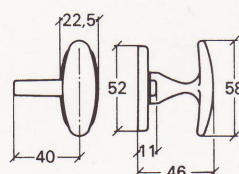

338D

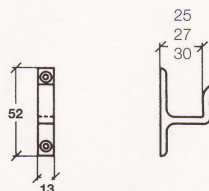

B482, mounting plate for 338D, thickness 1 mm

337

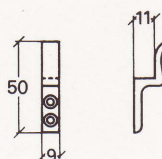

70

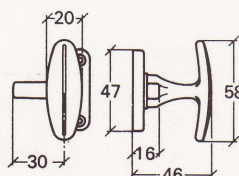

77D

